

ROAD NAME	ROAD CLASSIFICATION	ROAD LAYOUT TABLE							
		RESERVE WIDTH (m)	ROAD WIDTH			KERB TYPE		VERGE WIDTH(m)	
			LIP to LIP	INV to INV	BACK to BACK	NTHWEST	STHEAST	NTHWEST	STHEAST
LOGAN STREET	AS2	19.80	6.75	7.65	7.95	B2	B2	5.05	7.10
NAVARRE ROAD	AS1	16.00	6.60	7.50	7.80	B2	B2	4.25	4.25
CROWLANDS CIRCUIT EAST (LOTS 8017-8118)	AS1	16.00	6.60	7.50	7.80	B2	B2	4.25	4.25
CROWLANDS CIRCUIT WEST (LOTS 8072-8097)	AS1	16.00	6.60	7.50	7.80	B2	B2	4.25	4.25
CROWLANDS CIRCUIT NORTH (LOTS 8031-8059)	AP	14.00	6.60	7.50	7.80	B2	B2	1.25	5.25
LANDSBOROUGH LANE	AL	8.00	6.00	-	-	-	-	1.00	1.00
AMPHITHEATRE STREET	AP	16.00	6.60	7.50	7.80	B2	B2	4.25	4.25
JOEL WAY	AP	14.00	6.60	7.50	7.80	B2	B2	0.90	5.60
MOONABEL ROAD	AS1	16.00	6.60	7.50	7.80	B2	B2	4.25	4.25
GREEN HILL ROAD	AS2	24.00	9.50	10.40	10.70	B2	B2	6.80	6.80
EXTENDED DRIVEWAY (LOTS 8048-8053)	AL	7.50	5.50	-	-	-	-	-	2.00
WAANYARRA LANE	AL	8.00	6.00	-	-	-	-	1.00	1.00

ROAD NAME	SIDE	SERVICES OFFSET SCHEDULE									
		GAS		WATER		RECYCLED WATER		ELECTRICITY		TELECOMMS	
		OFFSET (m)	DEPTH (m)	OFFSET (m)	DEPTH (m)	OFFSET (m)	DEPTH (m)	OFFSET (m)	DEPTH (m)	OFFSET (m)	DEPTH (m)
LOGAN STREET	WEST	2.10	-	3.10	-	2.60	-	2.60	-	1.85	-
NAVARRE ROAD	NORTH	1.80	-	2.80	-	2.30	-	2.40	-	1.80	-
CROWLANDS CIRCUIT EAST (LOTS 8017-8118)	WEST	1.80	-	2.80	-	2.30	-	2.50	-	1.85	-
CROWLANDS CIRCUIT WEST (LOTS 8072-8097)	EAST	1.80	-	2.80	-	2.30	-	2.40	-	1.80	-
CROWLANDS CIRCUIT NORTH (LOTS 8031-8059)	SOUTH	1.80	-	2.80	-	2.30	-	3.60	-	1.00	-
AMPHITHEATRE STREET	EAST	1.80	-	2.80	-	2.30	-	2.45	-	1.80	-
JOEL WAY	SOUTH	1.80	-	2.80	-	2.30	-	4.30	-	3.40	-
MOONABEL ROAD	NORTH	1.80	-	2.80	-	2.30	-	2.55	-	1.80	-
GREEN HILL ROAD	WEST	2.10	-	3.60	-	2.80	-	2.60	-	1.85	-
EXTENDED DRIVEWAY (LOTS 8048-8053)	SOUTH	1.40	-	0.60	-	1.00	-	-0.50	-	-1.00	-
LAMPLOUGH WALK	SOUTH	1.50	-	2.50	-	2.00	-	0.40	-	0.90	-
LANDSBOROUGH LANE (MC08)	-	-	-	-	-	-	-	0.50	-	-	-
WAANYARRA LANE	-	-	-	-	-	-	-	0.50	-	-	-

LEGEND

- PROPOSED STAGE BOUNDARY
- 5.0 PROPOSED DESIGN CONTOURS
- PROPOSED KERB & CHANNEL
- FALL OF ALLOTMENT
- DIRECTION OF OVERLAND FLOW
- PROPOSED STORMWATER DRAINAGE
- PROPOSED PIT LABEL
- PROPOSED SEWERAGE RETICULATION
- PROPOSED WATER RETICULATION
- PROPOSED RECYCLED WATER RETICULATION
- PROPOSED ELECTRICITY UNDER GROUND
- PROPOSED COMMUNICATIONS
- PROPOSED GAS RETICULATION
- PROPOSED DRAINAGE INLET
- PROPOSED CONCRETE FOOTPATH/DRIVEWAY
- PROPOSED SHARED PATH
- PROPOSED ROAD PAVEMENT
- PROPOSED GAS / CLASS A / POTABLE WATER HOUSE CONNECTION
- BOLLARD
- FR98.86 FINISHED RIDGE LEVEL
- FS97.14 FINISHED SURFACE LEVEL
- TW98.16 TOP OF WALL LEVEL
- BW98.16 BOTTOM OF WALL LEVEL
- 93.750 EXISTING SURFACE LEVEL
- PROPOSED RETAINING WALL
- PROPOSED RIDGE LINE
- CUT (> 0.2m)
- FILL (> 0.2m)
- EXISTING STAGE BOUNDARY
- 5.0 EXISTING SURFACE CONTOURS
- EXISTING STORMWATER DRAINAGE
- EXISTING SEWER RETICULATION
- EXISTING WATER RETICULATION
- EXISTING RECYCLED WATER RETICULATION
- EXISTING ELECTRICITY UNDER GROUND
- EXISTING COMMUNICATIONS
- EXISTING GAS RETICULATION
- EXISTING SWALE
- FUTURE STORMWATER DRAINAGE
- FUTURE SEWER RETICULATION
- FUTURE WATER RETICULATION
- FUTURE RECYCLED WATER RETICULATION
- FUTURE COMMUNICATIONS
- FUTURE ELECTRICAL UNDER GROUND
- FUTURE GAS RETICULATION
- EXISTING TREES TO BE RETAINED
- EXISTING TREES TO BE REMOVED

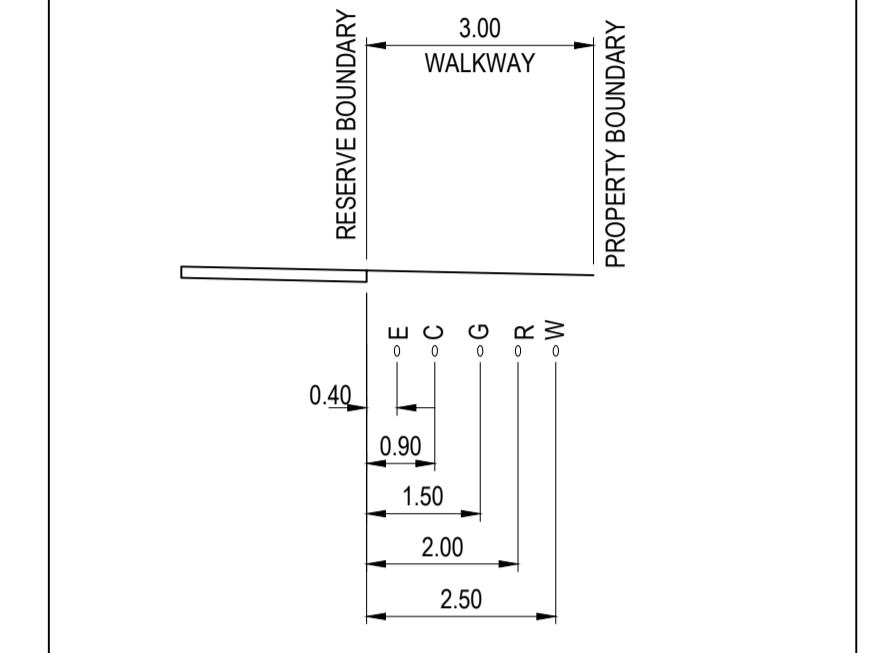

LAMPLOUGH WALK - TYPICAL SECTION
SCALE: 1:100

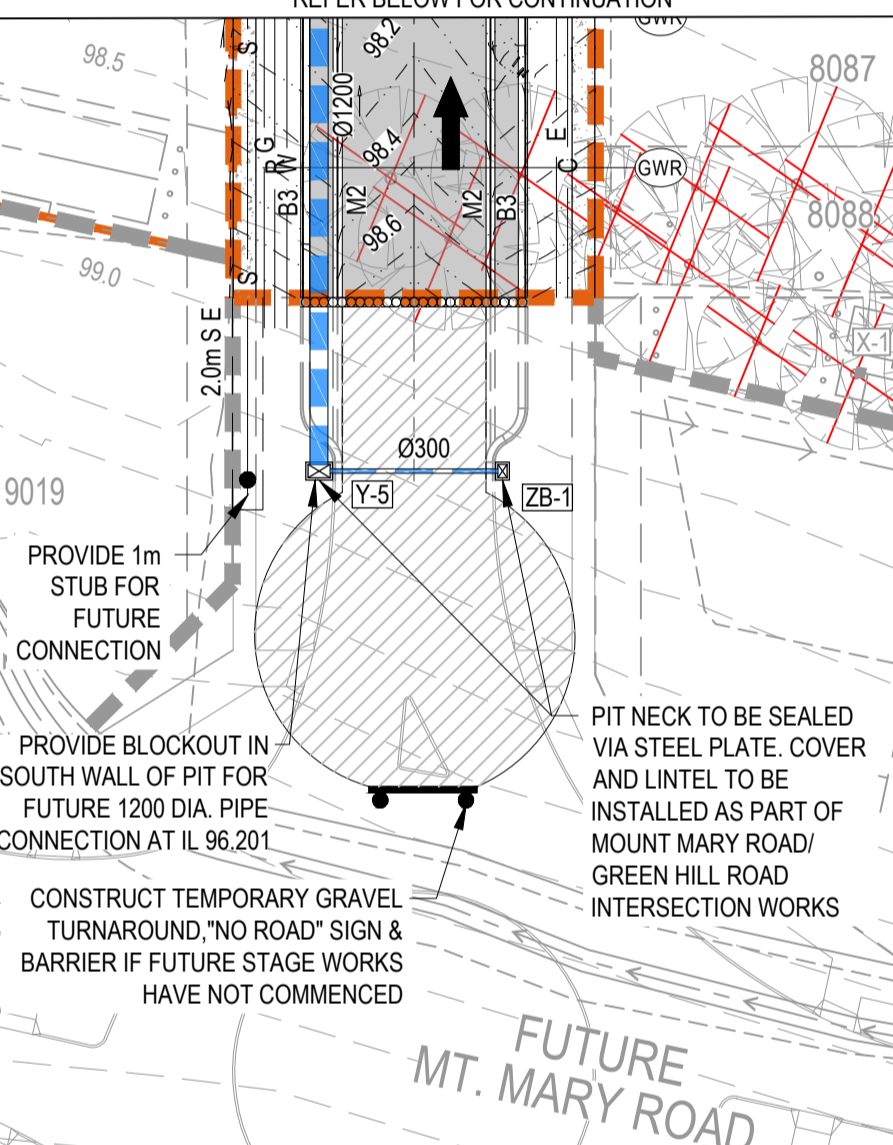

INSET - A

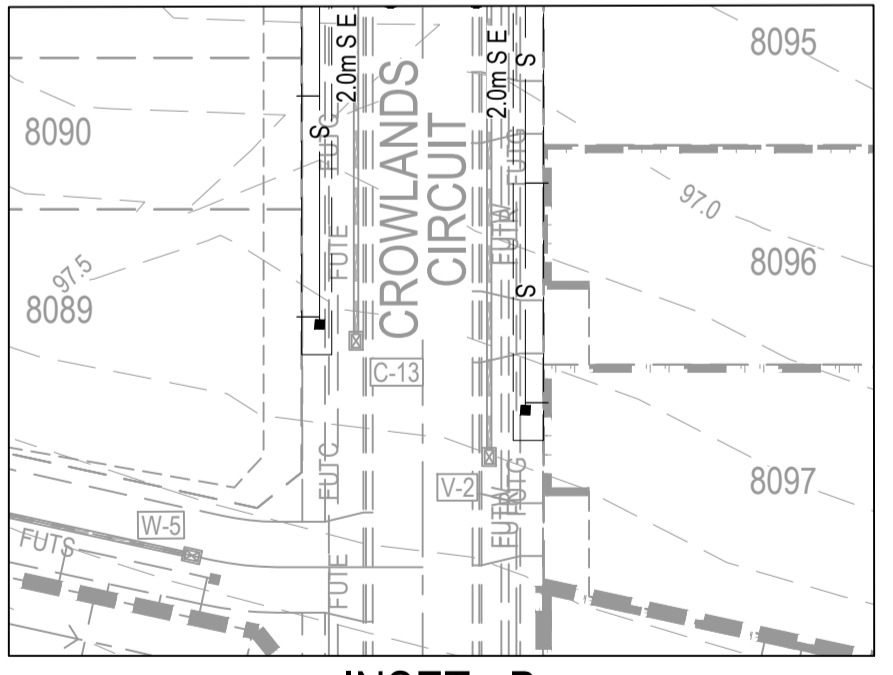

INSET - B

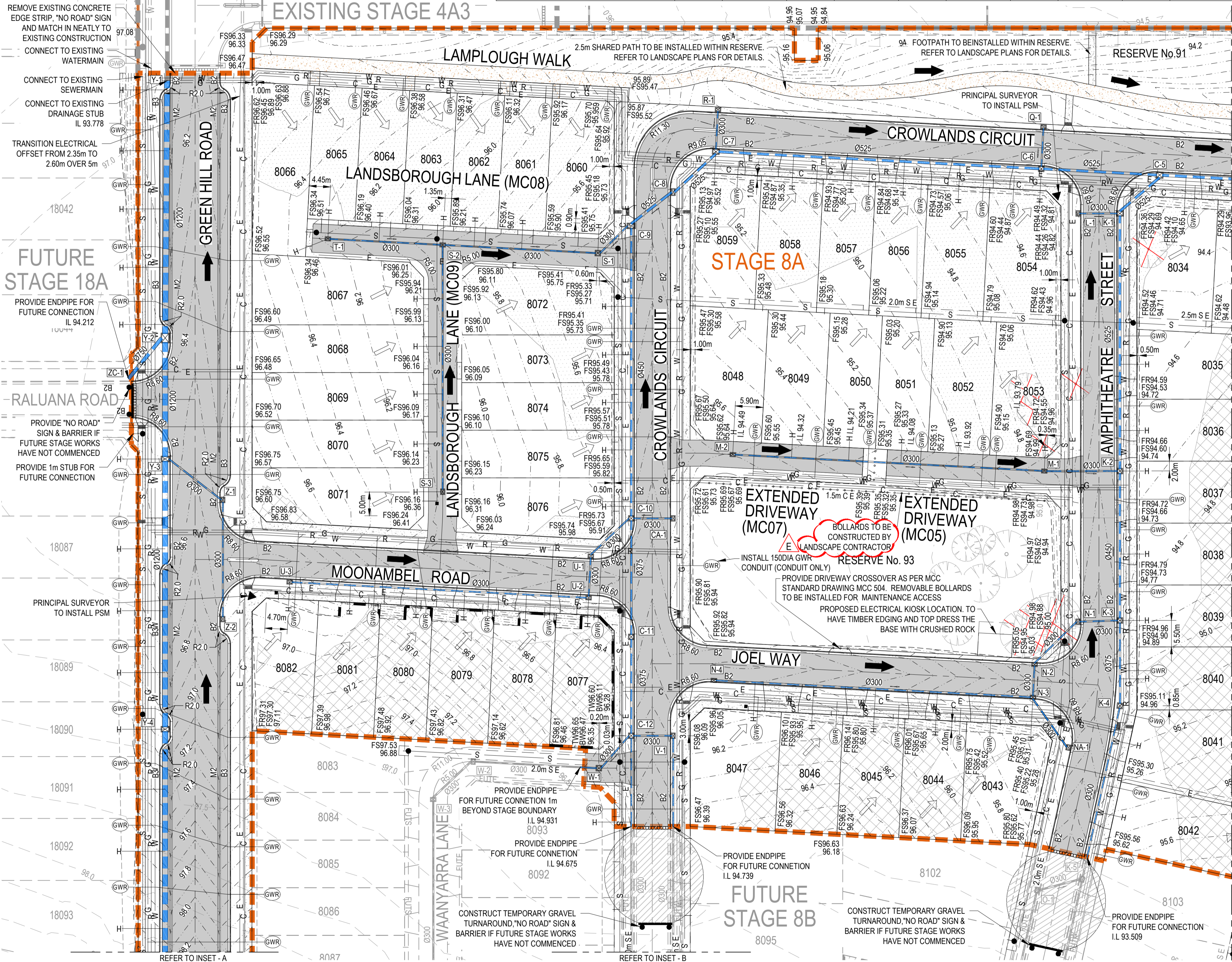

Issue	Description	By	Ckd	PM	Date
E	AS CONSTRUCTED	WB	ZS	SE	07.10.21
D	UPDATES TO RESERVE No. 91	WB	ZS	SE	18.08.21
C	UPDATES TO SERVICE COORDINATION	MD	ZS	SE	18.11.20
B	UPDATES TO SERVICE COORDINATION	MD	ZS	SE	11.11.20
A	ISSUED FOR CONSTRUCTION	WB	ZS	SE	13.10.20
04	UPDATES TO ADDRESS COUNCIL COMMENTS	WB	ZS	SE	07.08.20
03	UPDATES TO ADDRESS COUNCIL COMMENTS	MD	ZS	SE	17.07.20
02	ISSUED FOR APPROVAL	MD	ZS	SE	24.06.20
01	ISSUED TO CLIENT FOR REVIEW	WB	ZS	SE	04.10.19

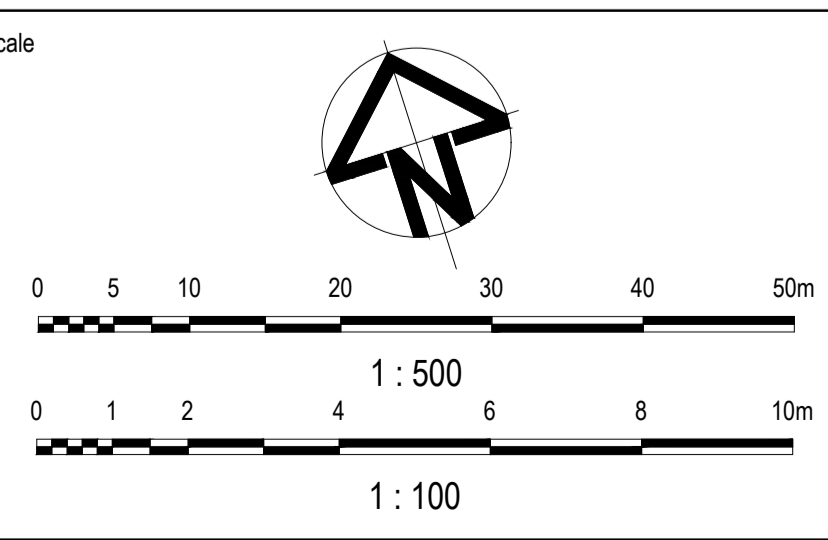

AS CONSTRUCTED RECORDS

THE OBJECTIVE OF THESE 'AS-CONSTRUCTED RECORDS' IS TO REFLECT ANY SIGNIFICANT CHANGES TO THE APPROVED CONSTRUCTION DRAWINGS AND PROVIDE COUNCIL WITH A RECORD OF DESIGN INTENT. ANY LEVELS AND COORDINATES SHOWN ON THESE PLANS ARE SUBJECT TO SURVEY AND WILL DIFFER. ARCADIS ACCEPTS NO RESPONSIBILITY FOR LOSS OR DAMAGES RESULTING FROM THE INTERPRETATION OF THESE DRAWINGS. ALL DETAILS AND ASSETS MUST BE ASCERTAINED AND VERIFIED BY THE END USER.

MAX OUP

Status	AS CONSTRUCTED
Verifier	Z.STROGUSZ
Scales	AS SHOWN
Original Size	A1
Height Datum	AHD
Grid	MGA

Project: EYNEBURY TOWNSHIP STAGE 8A

Title: ROADWORKS AND DRAINAGE LAYOUT PLAN SHEET 1 OF 2

ARCADIS

Arcadis Australia Pacific Pty Limited
Level 32, 140 William Street
Melbourne VIC 3000
ABN 76 104 485 289
Tel No: +61 3 8623 4000
www.arcadis.com

Project No: 10029435
Issue: E

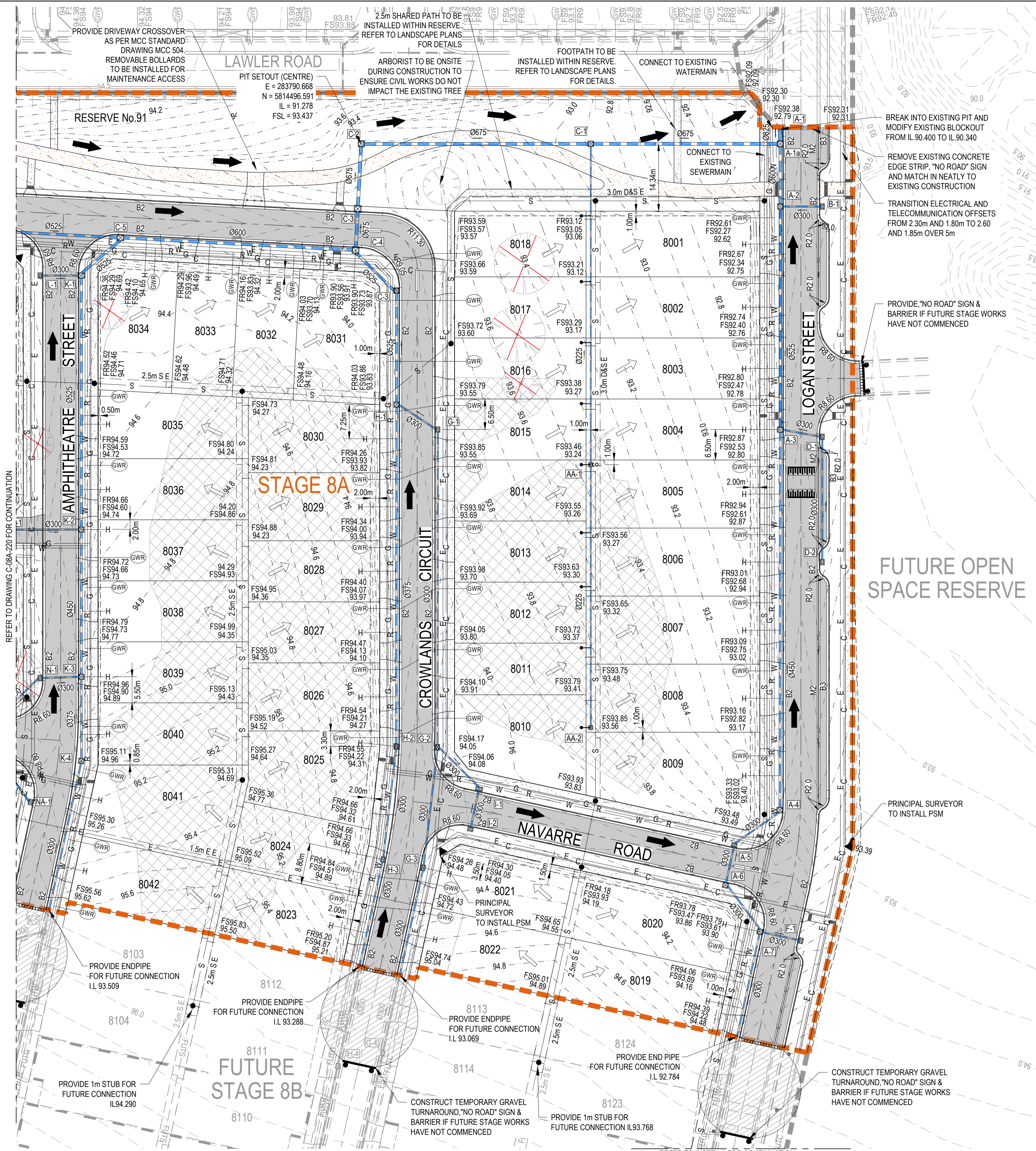

AS CONSTRUCTED RECORDS

THE OBJECTIVE OF THESE 'AS-CONSTRUCTED DRAWINGS' IS TO REFLECT ANY SIGNIFICANT CHANGES TO THE APPROVED CONSTRUCTION DRAWINGS AND PROVIDE COUNCIL WITH A RECORD OF DESIGN INTENT. ANY LEVELS AND COORDINATES SHOWN ON THESE PLANS ARE SUBJECT TO SURVEY AND WILL DIFFER. ARCADIS ACCEPTS NO RESPONSIBILITY FOR LOSS OR DAMAGES RESULTING FROM THE INTERPRETATION OF THESE DRAWINGS. ALL DETAILS AND ASSETS MUST BE ASCERTAINED AND VERIFIED BY THE END USER.



LEGEND	
	PROPOSED STAGE BOUNDARY
	5.0 PROPOSED DESIGN CONTOURS
	PROPOSED KERB & CHANNEL
	FALL OF ALLOTMENT
	DIRECTION OF OVERLAND FLOW
	PROPOSED STORMWATER DRAINAGE
	PROPOSED PIT LABEL
	PROPOSED SEWERAGE RETICULATION
	PROPOSED WATER RETICULATION
	PROPOSED RECYCLED WATER RETICULATION
	PROPOSED ELECTRICITY UNDER GROUND
	PROPOSED COMMUNICATIONS
	PROPOSED GAS RETICULATION
	PROPOSED DRAINAGE INLET
	PROPOSED CONCRETE FOOTPATH/DRIVEWAY
	PROPOSED SHARED PATH
	PROPOSED ROAD PAVEMENT
	PROPOSED GAS / CLASS A / POTABLE WATER HOUSE CONNECTION
	BOLLARD
	FINISHED RIDGE LEVEL
	FINISHED SURFACE LEVEL
	TOP OF WALL LEVEL
	BOTTOM OF WALL LEVEL
	EXISTING SURFACE LEVEL
	PROPOSED RETAINING WALL
	PROPOSED RIDGE LINE
	CUT (> 0.2m)
	FILL (> 0.2m)
	EXISTING STAGE BOUNDARY
	5.0 EXISTING SURFACE CONTOURS
	EXISTING STORMWATER DRAINAGE
	EXISTING SEWER RETICULATION
	EXISTING WATER RETICULATION
	EXISTING RECYCLED WATER RETICULATION
	EXISTING ELECTRICITY UNDER GROUND
	EXISTING COMMUNICATIONS
	EXISTING GAS RETICULATION
	EXISTING SWALE
	FUTURE STORMWATER DRAINAGE
	FUTURE SEWER RETICULATION
	FUTURE WATER RETICULATION
	FUTURE RECYCLED WATER RETICULATION
	FUTURE COMMUNICATIONS
	FUTURE ELECTRICAL UNDER GROUND
	FUTURE GAS RETICULATION
	EXISTING TREES TO BE RETAINED
	EXISTING TREES TO BE REMOVED

NOTE:
FOR GENERAL NOTES, REFER TO DRAWING No. C-08A-002.



Issue	Description	By	Ckd	PM	Date
D	AS CONSTRUCTED	WB	ZS	SE	07.10.21
C	UPDATES TO RESERVE No. 91	WB	ZS	SE	18.08.21
B	UPDATES TO SERVICE COORDINATION	OP	ZS	SE	11.11.20
A	ISSUED FOR CONSTRUCTION	WB	ZS	SE	13.10.20
05	FOOTPATH IN RESERVE No.91 AMENDED	WB	ZS	SE	10.09.20
04	UPDATES TO ADDRESS COUNCIL COMMENTS	WB	ZS	SE	07.08.20
03	UPDATES TO ADDRESS COUNCIL COMMENTS	MD	ZS	SE	17.07.20
02	ISSUED FOR APPROVAL	MD	ZS	SE	24.06.20
01	ISSUED TO CLIENT FOR REVIEW	WB	ZS	SE	04.10.19

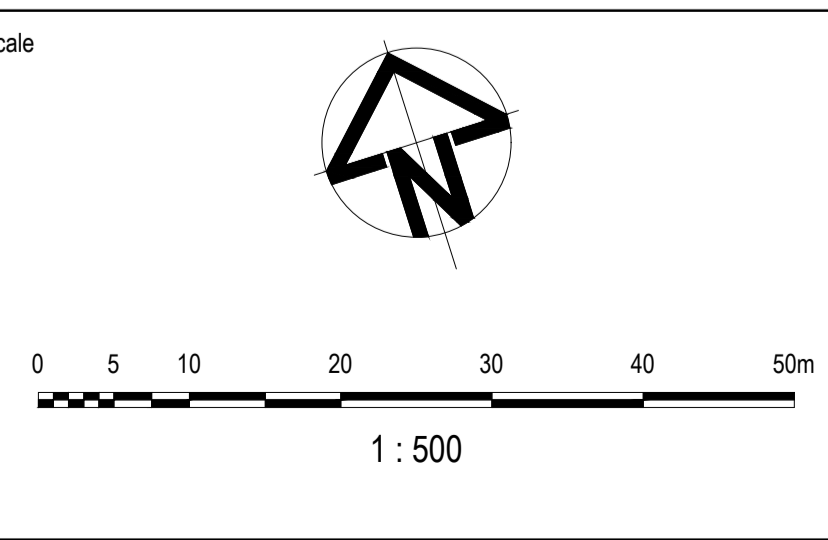

Planner

Client

Filename C-08a-221-10029435-Roadworks&DrainagePlanSheet2.dwg

Status	AS CONSTRUCTED
Verifier	Z.STROGUSZ
Scales	1:500
Original Size	A1
Height Datum	AHD
Grid	MGA

Project	EYNEBURY TOWNSHIP STAGE 8A
Title	ROADWORKS AND DRAINAGE LAYOUT PLAN SHEET 2 OF 2

Arcadis Australia Pacific Pty Limited
Level 32, 140 William Street
Melbourne VIC 3000
ABN 76 104 485 289
Tel No: +61 3 8623 4000
www.arcadis.com

Drawing No. C-08A-221
Project No. 10029435
Issue D