

LEGEND

- PROPOSED STAGE BOUNDARY
- 5.0 PROPOSED DESIGN CONTOURS
- PROPOSED KERB & CHANNEL
- FALL OF ALLOTMENT
- DIRECTION OF OVERLAND FLOW
- PROPOSED STORMWATER DRAINAGE
- [A-I] PROPOSED PIT LABEL
- S PROPOSED SEWERAGE RETICULATION
- W PROPOSED WATER RETICULATION
- R PROPOSED RECYCLED WATER RETICULATION
- E PROPOSED ELECTRICITY UNDER GROUND
- C PROPOSED COMMUNICATIONS
- G PROPOSED GAS RETICULATION
- PROPOSED DRAINAGE INLET
- [Pattern] PROPOSED CONCRETE FOOTPATH/DRIVEWAY
- [Pattern] PROPOSED ROAD PAVEMENT
- (GWR) PROPOSED GAS / CLASS A / POTABLE WATER HOUSE CONNECTION
- BOLLARD
- FR88.86 FINISHED RIDGE LEVEL
- FS97.14 FINISHED SURFACE LEVEL
- 93.750 EXISTING SURFACE LEVEL
- - - PROPOSED RIDGE LINE
- [Pattern] CUT (> 0.3m)
- [Pattern] FILL (> 0.3m)
- EXISTING STAGE BOUNDARY
- 5.0 EXISTING SURFACE CONTOURS
- EXISTING STORMWATER DRAINAGE
- S EXISTING SEWER RETICULATION
- W EXISTING WATER RETICULATION
- R EXISTING RECYCLED WATER RETICULATION
- e EXISTING ELECTRICITY UNDER GROUND
- c EXISTING COMMUNICATIONS
- g EXISTING GAS RETICULATION
- EXISTING SWALE
- FUTURE STORMWATER DRAINAGE
- FUTS FUTURE SEWER RETICULATION
- FUTW FUTURE WATER RETICULATION
- FUTR FUTURE RECYCLED WATER RETICULATION
- FUTC FUTURE COMMUNICATIONS
- FUTE FUTURE ELECTRICAL UNDER GROUND
- FUTG FUTURE GAS RETICULATION
- (Tree) EXISTING TREES TO BE RETAINED
- (Tree) EXISTING TREES TO BE REMOVED
- PROPOSED FENCE

NOTES:
 1. FUTURE STAGE 5C TO BE CONSTRUCTED CONCURRENTLY.

ROAD NAME	ROAD CLASSIFICATION	RESERVE WIDTH (m)	ROAD WIDTH			KERB TYPE		VERGE WIDTH(m)	
			LIP to LIP	INV to INV	BACK to BACK	NTH/WEST	STH/EAST	NTH/WEST	STH/EAST
COBRAM DRIVE	AS2	16.00	6.40	7.30	7.60	B2	B2	4.35	4.35
BUNDALONG DRIVE	AS1	14.00	6.40	7.30	7.60	B2	B2	4.35	2.35
BARMAH WAY	AP	16.00	6.40	7.30	7.60	B2	B2	4.35	4.35
BENDIGO DRIVE	AS2	20.00	9.50	10.40	10.70	B2	B2	4.80	4.80

ROAD NAME	GAS		WATER		RECYCLED WATER		ELECTRICITY		TELECOMMS	
	SIDE	OFFSET (m)	SIDE	OFFSET (m)	SIDE	OFFSET (m)	SIDE	OFFSET (m)	SIDE	OFFSET (m)
COBRAM DRIVE	NORTH	1.80	NORTH	2.80	NORTH	2.30	SOUTH	2.60	SOUTH	1.80
BUNDALONG DRIVE	SOUTH	1.80	SOUTH	2.80	SOUTH	2.30	NORTH	0.90	NORTH	0.40
BARMAH WAY	WEST	1.80	WEST	2.80	WEST	2.30	EAST	2.60	EAST	1.80
BENDIGO DRIVE	EAST	1.80	EAST	2.80	EAST	2.30	WEST	2.60	WEST	1.80

Issue	Description	By	Ckd	PM	Date
A	ISSUED FOR CONSTRUCTION	CM	ZS	JM	28.10.21
03	FENCE NOTE CHANGED	CM	ZS	JM	07.10.21
02	AMENDED FOR COUNCIL RFI	CM	ZS	JM	25.08.21
01	ISSUED FOR APPROVAL	WB	ZS	JM	02.08.21

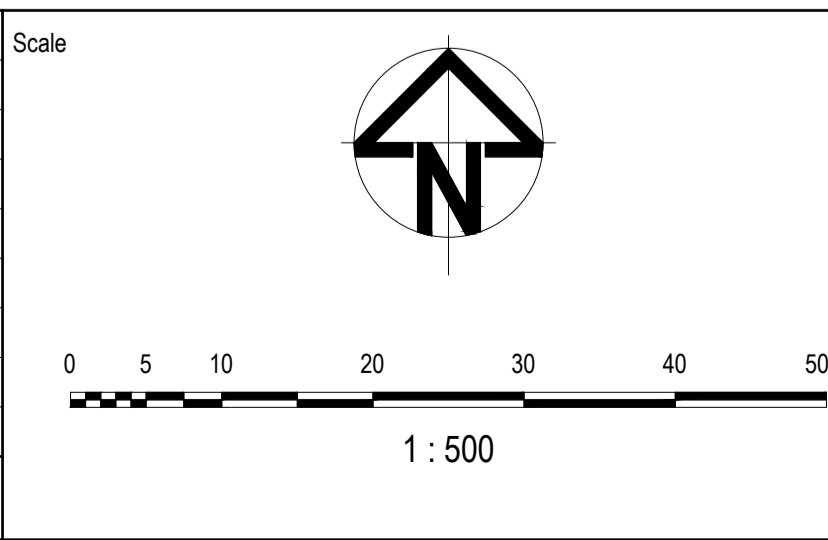

Planner

Client

Filename C-13A-220-10029435-Roadworks&DrainagePlan.dwg

Status

FOR CONSTRUCTION

Checker

Z.STROGUSZ

Scales

1:500

Original Issue Signatures

Drawn

W.BUMAGAT

Designed

K.ANGELES

Original Size

A1

Height

AHD

Datum

J.MUNRO

Project Manager

Grid

MGA

© Copyright reserved

Project

EYNEBURY TOWNSHIP
STAGE 13A

Title

ROADWORKS AND DRAINAGE
LAYOUT PLAN
SHEET 1 OF 2

Arcadis Australia Pacific Pty Limited
Level 32, 140 William Street
Melbourne VIC 3000
ABN 76 104 485 289
Tel No: +61 3 8623 4000
www.arcadis.com

Drawing No. C-13A-220

Project No. 10029435

Issue A

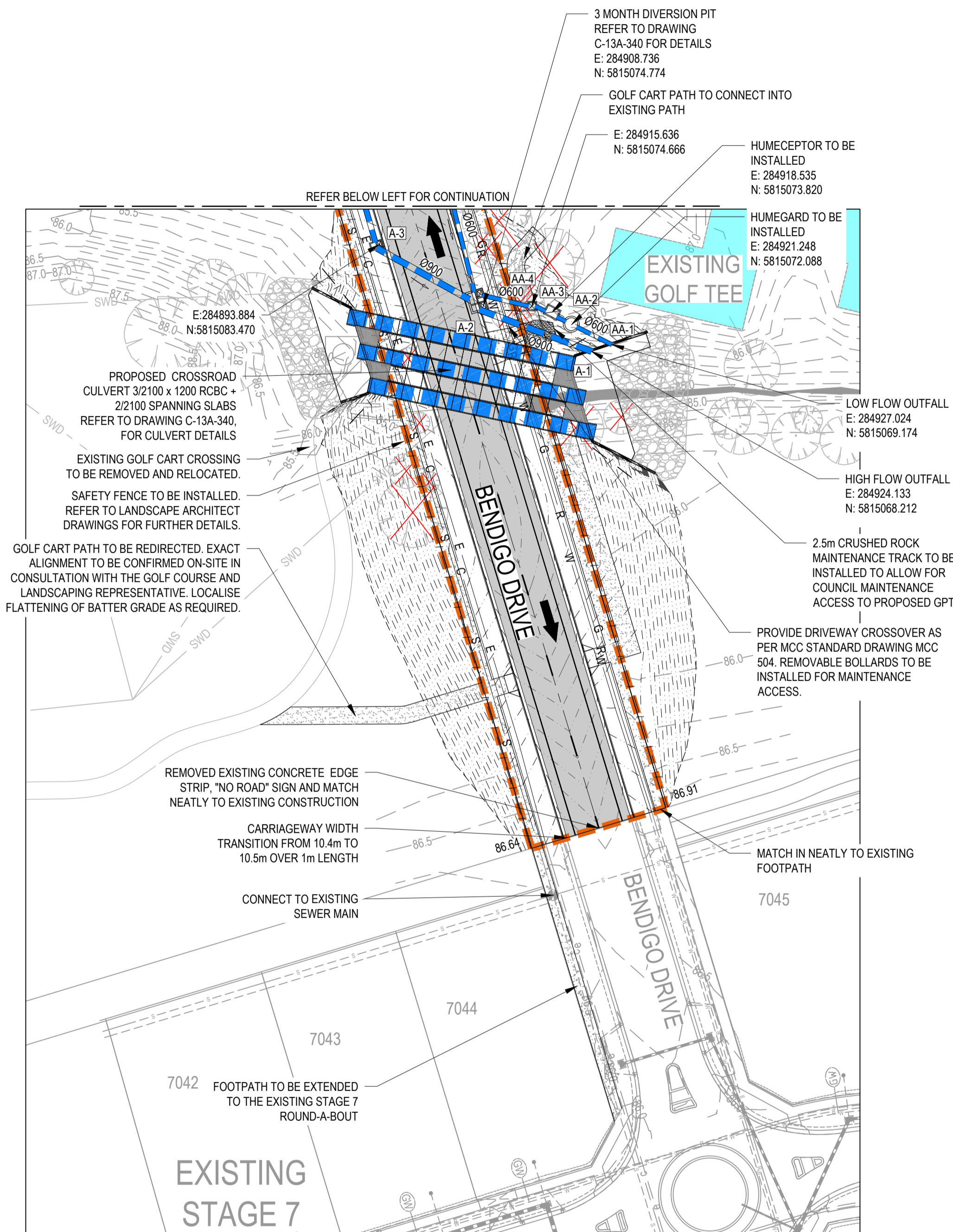
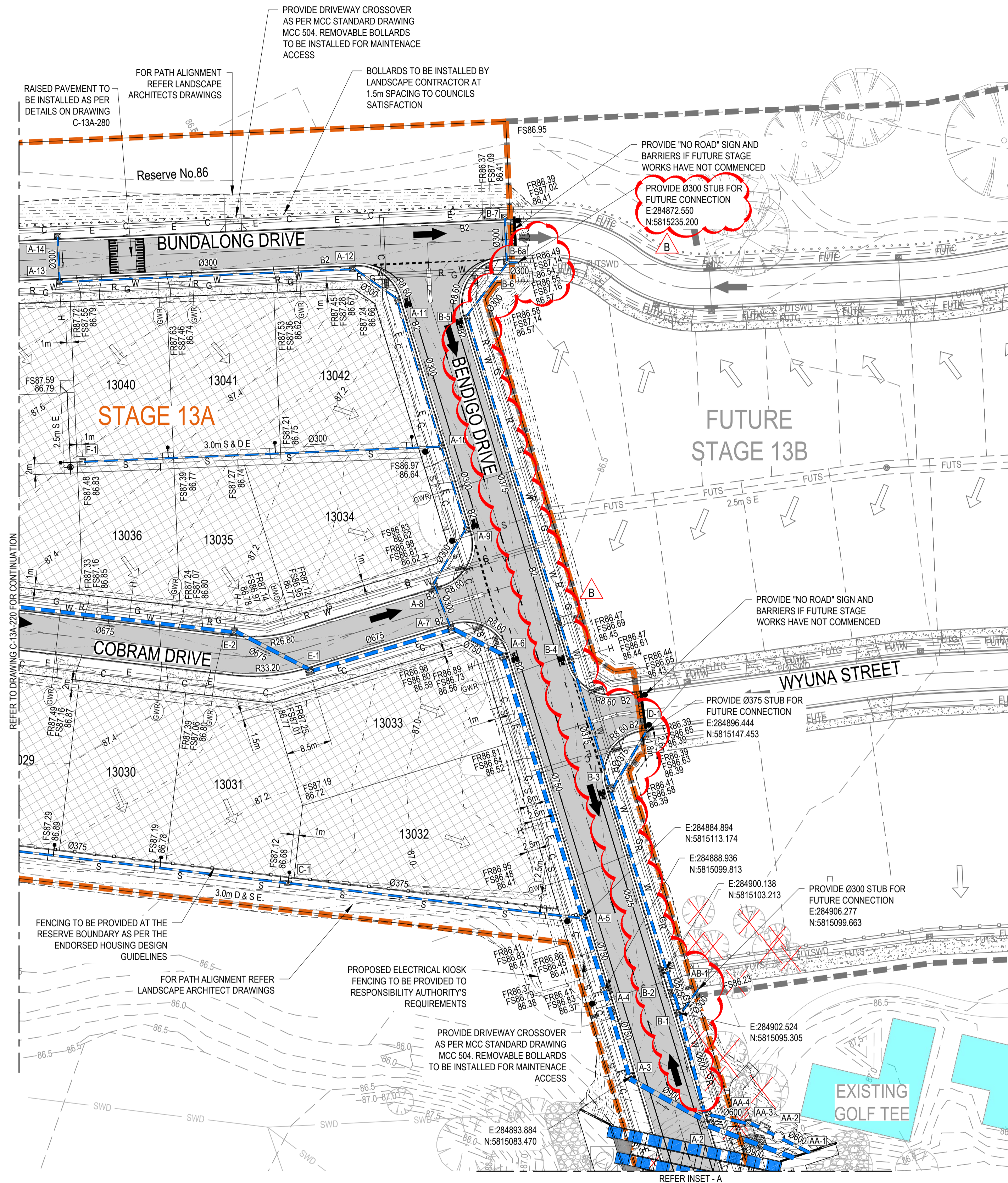

LEGEND	
	PROPOSED STAGE BOUNDARY
	5.0 PROPOSED DESIGN CONTOURS
	PROPOSED KERB & CHANNEL
	FALL OF ALLOTMENT
	DIRECTION OF OVERLAND FLOW
	PROPOSED STORMWATER DRAINAGE
	PROPOSED PIT LABEL
	PROPOSED SEWERAGE RETICULATION
	PROPOSED WATER RETICULATION
	PROPOSED RECYCLED WATER RETICULATION
	PROPOSED ELECTRICITY UNDER GROUND
	PROPOSED COMMUNICATIONS
	PROPOSED GAS RETICULATION
	PROPOSED DRAINAGE INLET
	PROPOSED CONCRETE FOOTPATH/DRIVEWAY
	PROPOSED ROAD PAVEMENT
	PROPOSED GAS / CLASS A / POTABLE WATER HOUSE CONNECTION
	BOLLARD
	FINISHED RIDGE LEVEL
	FINISHED SURFACE LEVEL
	EXISTING SURFACE LEVEL
	PROPOSED RIDGE LINE
	CUT (> 0.3m)
	FILL (> 0.3m)
	EXISTING STAGE BOUNDARY
	5.0 EXISTING SURFACE CONTOURS
	EXISTING STORMWATER DRAINAGE
	EXISTING SEWER RETICULATION
	EXISTING WATER RETICULATION
	EXISTING RECYCLED WATER RETICULATION
	EXISTING ELECTRICITY UNDER GROUND
	EXISTING COMMUNICATIONS
	EXISTING GAS RETICULATION
	EXISTING SWALE
	FUTURE STORMWATER DRAINAGE
	FUTURE SEWER RETICULATION
	FUTURE WATER RETICULATION
	FUTURE RECYCLED WATER RETICULATION
	FUTURE COMMUNICATIONS
	FUTURE ELECTRICAL UNDER GROUND
	FUTURE GAS RETICULATION
	EXISTING TREES TO BE RETAINED
	EXISTING TREES TO BE REMOVED
	PROPOSED FENCE

NOTES:
1. FUTURE STAGE 5C TO BE CONSTRUCTED CONCURRENTLY.

Issue	Description	By	Ckd	PM	Date
B	UPDATES TO 13B STORMWATER CONNECTIONS	CM	ZS	JM	01.12.21
A	ISSUED FOR CONSTRUCTION	CM	ZS	JM	28.10.21
03	FENCE NOTE CHANGED	CM	ZS	JM	07.10.21
02	AMENDED FOR COUNCIL RFI	CM	ZS	JM	25.08.21
01	ISSUED FOR APPROVAL	WB	ZS	JM	02.08.21

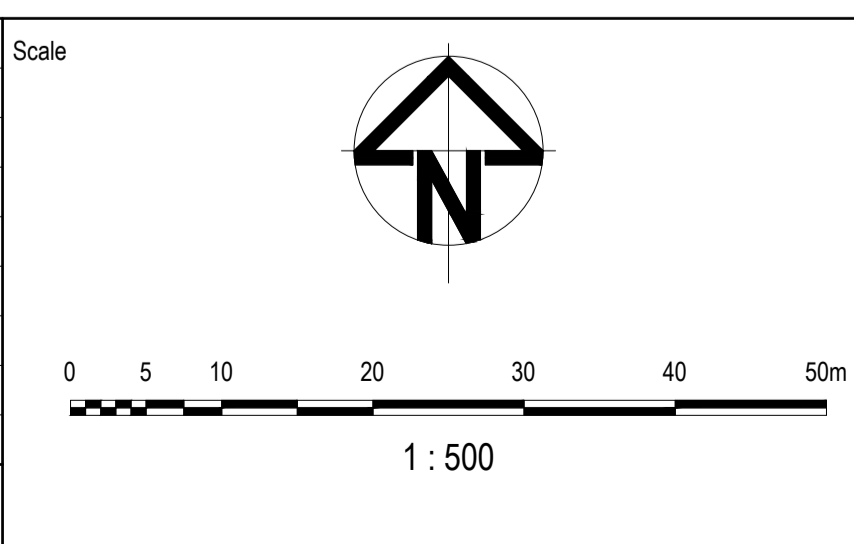

Planner

RobertsDay
planning.design.place

Client

RESIMAX
GROUP

Filename C-13A-221-10029435-Roadworks&DrainagePlan.dwg

Status	FOR CONSTRUCTION	
Checker	Z.STROGUSZ	
Scales	1:500	Original Issue Signatures
Original Size	A1	Drawn W.BUMAGAT
Height Datum	AHD	Designed K.ANGELES
Grid	MGA	Project Manager J.MUNRO
		© Copyright reserved

Project	EYNEBURY TOWNSHIP STAGE 13A
Title	ROADWORKS AND DRAINAGE LAYOUT PLAN SHEET 2 OF 2

Arcadis Australia Pacific Pty Limited
Level 32, 140 William Street
Melbourne VIC 3000
ABN 76 104 485 289
Tel No: +61 3 8623 4000
www.arcadis.com

Drawing No. C-13A-221
Project No. 10029435
Issue B