

PLAN OF SUBDIVISION		EDITION 1	PS543210K/S115	
LOCATION OF LAND PARISH: MOORADORANOOK REFER TO REGISTERED MASTER PLAN FOR CROWN DESCRIPTIONS TITLE REFERENCE: Vol. 11388 Fol. 754 LAST PLAN REFERENCE: Lot S115 on PS543210K POSTAL ADDRESS: St Arnaud Road (at time of subdivision) Eynesbury 3338 MGA 94 CO-ORDINATES: E: 283 800 ZONE: 55 (of approx centre of land in plan) N: 5815 550		Council Name: Melton City Council Council Reference Number: Sub 4760 Planning Permit Reference: 2011/3157 SPEAR Reference Number: S096906A Certification This plan is certified under section 11 (7) of the Subdivision Act 1988 Date of original certification under section 6: 12/04/2017 Public Open Space A requirement for public open space under section 18 of the Subdivision Act 1988 has not been made Digitally signed by: Geraldine Addicott for Melton City Council on 18/09/2020 Statement of Compliance issued: 25/09/2020		
VESTING OF ROADS AND/OR RESERVES		NOTATIONS		
IDENTIFIER	COUNCIL/BODY/PERSON			
Road R24 Reserve No.56	Melton City Council Melton City Council			
NOTATIONS				
DEPTH LIMITATION: NIL				
SURVEY: This plan is based on survey.				
STAGING: This is a staged subdivision. Planning Permit No. 2011/3157				
Release 115 (Eynesbury Marketing stage 11AW5) Area of Release: 2.212ha No. of Lots: 22 Lots				
EASEMENT INFORMATION				
LEGEND: A - Appurtenant Easement E - Encumbering Easement R - Encumbering Easement (Road)				
Easement Reference	Purpose	Width (Metres)	Origin	Land Benefited/In Favour Of
	Easements E-1, E-3 to E-12, E-14, E15 and E-17 to E-38 have been omitted from this plan. "Telecommunications" is defined as transmission of telecommunication signals by underground cables.			
E-2	Sewerage	See Diag.	This Plan	Western Region Water Corporation
E-13	Power Line	See Diagram	This Plan Section 88 Electricity Industry Act 2000	Powercor Australia Ltd.
	Water Supply		This Plan	Western Region Water Corporation
	Gas Pipeline		This Plan Section 146 Gas Industry Act 2001	SPI Networks (Gas) Pty. Ltd.
	Telecommunications		This Plan	Lots on this Plan
	Sewerage		This Plan	Western Region Water Corporation
E-16	Power Line	See Diagram	This Plan Section 88 Electricity Industry Act 2000	Powercor Australia Ltd.
E-39	Drainage	See Diagram	This Plan	Melton City Council
	Sewerage			Western Region Water Corporation
E-40	Drainage	See Diag.	This Plan	Melton City Council
TAYLORS		SURVEYORS FILE REF: Ref. 9283-11AW5 Ver. 10		ORIGINAL SHEET SIZE: A3 SHEET 1 OF 2
Urban Development Built Environments Infrastructure 8 / 270 Ferntree Gully Road, Notting Hill, Victoria, 3168 Tel: 61 3 9501 2800 Web: taylorstds.com.au		Digitally signed by: Leo Alexander Bateman, Licensed Surveyor, Surveyor's Plan Version (10), 03/09/2020, SPEAR Ref: S096906A		Land Use Victoria Plan Registered 11:57 AM 07/10/2020 Assistant Registrar of Titles

MGA94 ZONE 55

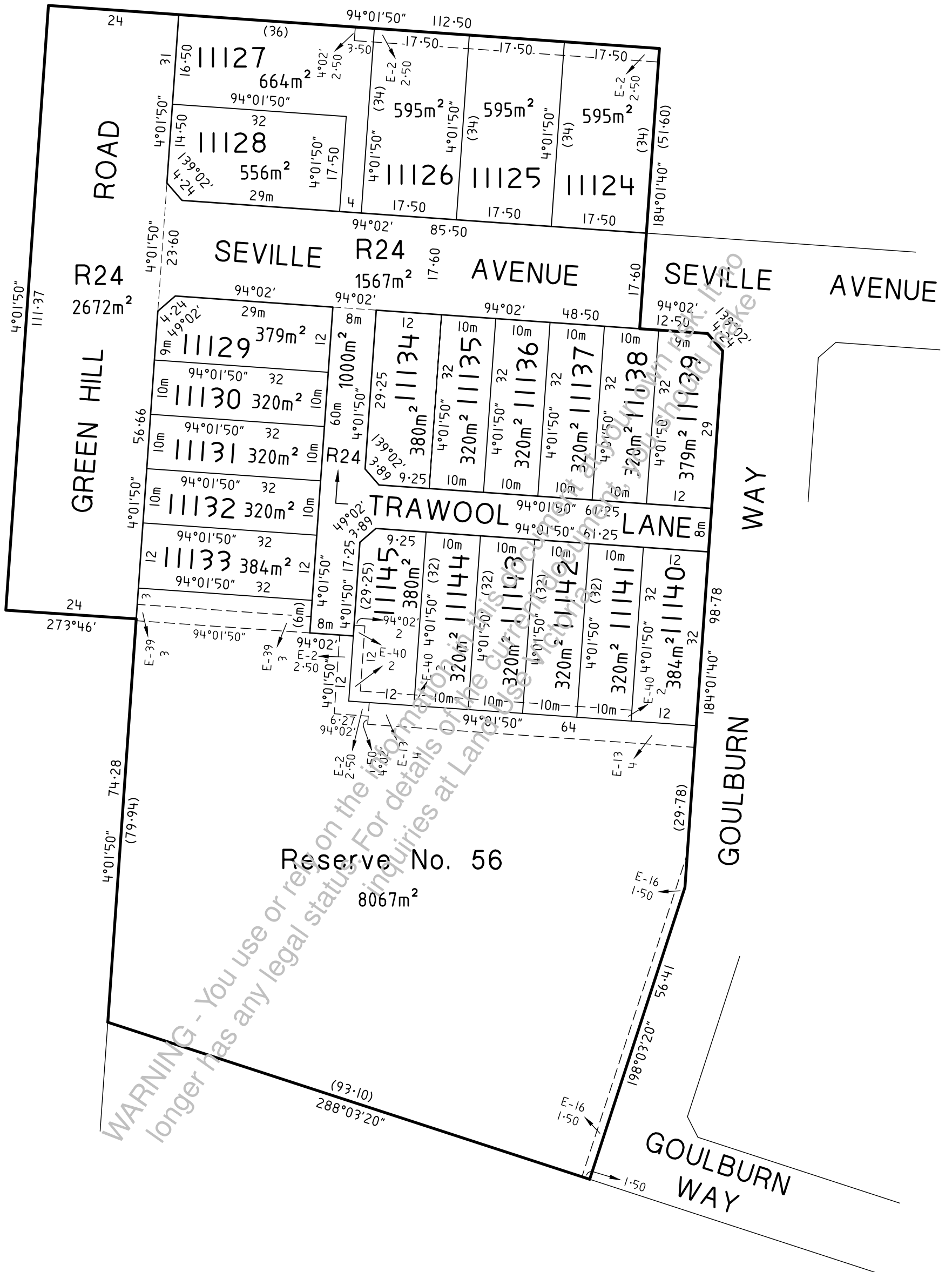

OWNERS CORPORATION SCHEDULE

PS543210K/S115

Owners Corporation No. 2 Plan No. PS543210K/S115

Land affected by Owners Corporation Lots: ALL OF THE LOTS IN THE TABLE BELOW
Common Property No.:

Limitations of Owners Corporation: UNLIMITED

Notations
NIL

Totals		
	Entitlement	Liability
This schedule	220	220
Previous stages	0	0
Overall Total	220	220

Lot Entitlement and Lot Liability

Lot	Entitlement	Liability	Lot	Entitlement	Liability	Lot	Entitlement	Liability	Lot	Entitlement	Liability
11124	10	10									
11125	10	10									
11126	10	10									
11127	10	10									
11128	10	10									
11129	10	10									
11130	10	10									
11131	10	10									
11132	10	10									
11133	10	10									
11134	10	10									
11135	10	10									
11136	10	10									
11137	10	10									
11138	10	10									
11139	10	10									
11140	10	10									
11141	10	10									
11142	10	10									
11143	10	10									
11144	10	10									
11145	10	10									

WARNING - You use or rely on the information in this document at your own risk. It no longer has any legal status. For details of the current document, you should make inquiries at Land Use Victoria.

SURVEYORS FILE REFERENCE: 9283-11AW5

SHEET 1

ORIGINAL SHEET
SIZE: A3



Urban Development | Built Environments
Infrastructure | Engineering and Project Management

8/270 Ferntree Gully Road, Notting Hill VIC 3168
Phone: (03) 9501 2800 | www.taylorsds.com.au

Digitally signed by: Leo Alexander Bateman, Licensed Surveyor,
Surveyor's Plan Version (10),
03/09/2020, SPEAR Ref: S096906A

Digitally signed by:
Melton City Council,
18/09/2020,
SPEAR Ref: S096906A