



PLAN OF SUBDIVISION		EDITION 1	PS543210K/S52	
LOCATION OF LAND <div style="text-align: center; font-size: 1.2em;">MOORADORANOOK</div> <div style="text-align: center;">REFER TO REGISTERED MASTER PLAN FOR CROWN DESCRIPTIONS</div> TITLE REFERENCE: Vol. Fol. LAST PLAN REFERENCE: PS543210K Lot S76 POSTAL ADDRESS: St Arnaud Road (at time of subdivision) EYNESBURY 3338 MGA 94 CO-ORDINATES: E: 284 350 ZONE: 55 (of approx centre of land N: 5 815 340 in plan)		Council Name: Melton City Council Council Reference Number: SUB4935 Planning Permit Reference: PA2017/5543-1 SPEAR Reference Number: S111967C Certification This plan is certified under section 6 of the Subdivision Act 1988 Public Open Space A requirement for public open space under section 18 of the Subdivision Act 1988 has not been made Digitally signed by: Michelle Hutchings for Melton City Council on 13/11/2019		
VESTING OF ROADS AND/OR RESERVES		NOTATIONS		
IDENTIFIER	COUNCIL/BODY/PERSON		Lots 5065, 5074 - 5082, and 5085 have been omitted from this plan.	
Road R41 Reserve No. 83	Melton City Council Melton City Council			
NOTATIONS				
DEPTH LIMITATION: NIL				
SURVEY: This plan is based on survey.				
STAGING: This is a staged subdivision. Planning Permit No. PA2017/5543-1				
EYNESBURY - Stage 52 (Eynesbury Marketing Stage 5B) Area of Release: 1.662ha No. of Lots: 20 Lots				
EASEMENT INFORMATION				
LEGEND: A - Appurtenant Easement E - Encumbering Easement R - Encumbering Easement (Road)				
Easement Reference	Purpose	Width (Metres)	Origin	Land Benefited/In Favour Of
E-1	Drainage	See Diag.	This Plan	Melton City Council
E-2	Sewerage	See Diag.	This Plan	Western Region Water Corporation
E-3	Drainage	See Diagram	This Plan	Melton City Council
	Sewerage			Western Region Water Corporation
		SURVEYORS FILE REF: Ref. 9283-S5B Ver. 3	ORIGINAL SHEET SIZE: A3	SHEET 1 OF 2
Urban Development Built Environments Infrastructure 8 / 270 Ferntree Gully Road, Notting Hill, Victoria, 3168 Tel: 61 3 9501 2800 Web: taylorstds.com.au		Digitally signed by: Leo Alexander Bateman, Licensed Surveyor, Surveyor's Plan Version (3), 31/10/2019, SPEAR Ref: S111967C		



SEE FUTURE RELEASE No. 5C FOR ADDITIONAL DRAINAGE & SEWERAGE EASEMENTS REQUIRED TO SERVICE LOTS ON THIS PLAN.

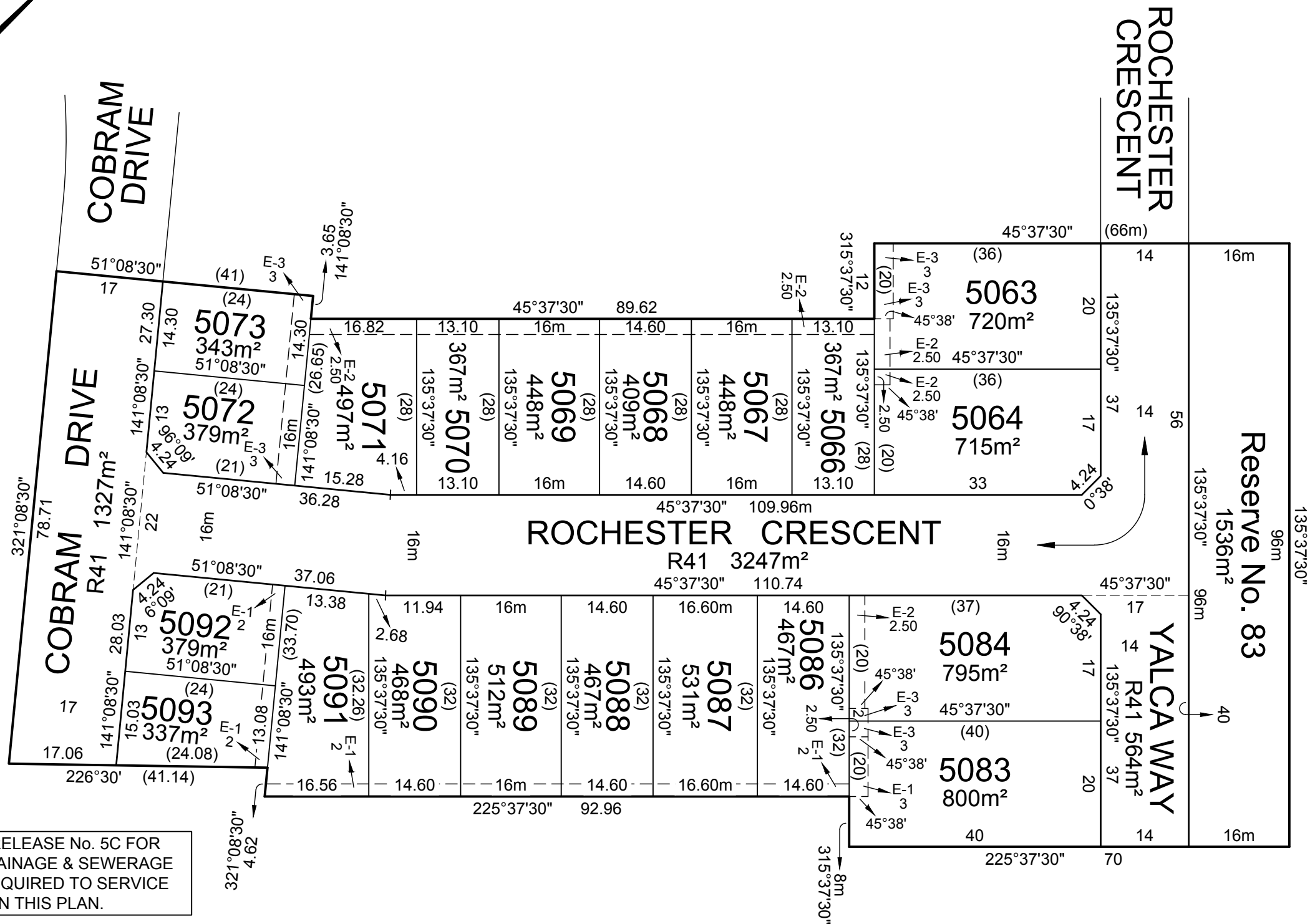
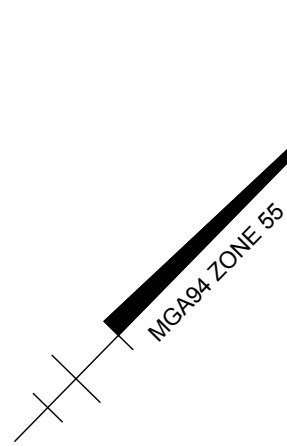

Urban Development | Built Environments | Infrastructure
 8 / 270 Ferntree Gully Road, Notting Hill, Victoria, 3168
 Tel: 61 3 9501 2800 | Web: taylorstds.com.au

SCALE
1:750

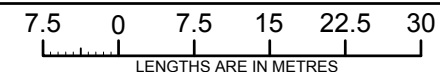

ORIGINAL SHEET
SIZE: A3

Ref. 9283-S5B
Ver. 3

SHEET 2

Digitally signed by: Leo Alexander Bateman, Licensed Surveyor,
 Surveyor's Plan Version (3),
 31/10/2019, SPEAR Ref: S111967C

Digitally signed by:
 Melton City Council,
 13/11/2019,
 SPEAR Ref: S111967C

OWNERS CORPORATION SCHEDULE

PS543210K/S52

Owners Corporation No. 1

Plan No. PS543210K

Land affected by Owners Corporation: ALL OF THE LOTS IN THE TABLE BELOW

Common Property No.: 2

Limitations of Owners Corporation: Unlimited

Notations

Totals		
	Entitlement	Liability
This schedule	200	200
Balance of existing OC	0	0
Overall Total	200	200

Lot Entitlement and Lot Liability

Lot	Entitlement	Liability	Lot	Entitlement	Liability	Lot	Entitlement	Liability	Lot	Entitlement	Liability
5063	10	10									
5064	10	10									
5066	10	10									
5067	10	10									
5068	10	10									
5069	10	10									
5070	10	10									
5071	10	10									
5072	10	10									
5073	10	10									
5083	10	10									
5084	10	10									
5086	10	10									
5087	10	10									
5088	10	10									
5089	10	10									
5090	10	10									
5091	10	10									
5092	10	10									
5093	10	10									



Urban Development | Infrastructure
8 / 270 Ferntree Gully Road, Notting Hill, Victoria, 3188
Tel: 61 3 9501 2800 | www.taylorsds.com.au

SURVEYORS FILE REFERENCE: 9283-S5B

SHEET 1

ORIGINAL SHEET
SIZE: A3

Digitally signed by: Leo Alexander Bateman, Licensed Surveyor,
Surveyor's Plan Version (3),
31/10/2019, SPEAR Ref: S111967C

Digitally signed by:
Melton City Council,
13/11/2019,
SPEAR Ref: S111967C