

ISSUE 4  
AUGUST 2022



# NE





# HELLO

Welcome to our quarterly newsletter, Eynesbury One!  
Your one-stop shop for developer updates, things to know, what's on and so much more!

If you want to be involved/advertised in the newsletter, email your contact details to our Community Development Manager; [ebbie@eynesbury.com.au](mailto:ebbie@eynesbury.com.au).

Developer Update & Destination Beyond

4

Announcements

10



What's On

24

Community Notice Board

26







# DEVELOPER UPDATE & DESTINATION BEYOND

This quarterly developer update will focus on Future of Eynesbury, Destination Beyond – a strong and uncompromising vision we have for Eynesbury & our community.



Artist Impression.

## Town Centre

Central to Eynesbury's vision is the future town centre, set to become a community hub like no other. Offering a mix of retail, commercial/conference facilities, entertainment, and community amenities, it will change the way Eynesburians eat, shop, and interact.

The planning application for the first stage of the town centre was lodged with Council in March 2022. Discussions around the layout of the town centre are continuing with Council and once agreed a formal planning permit will be issued. Resimax is expecting the permit will be granted before the end of the calendar year.







## Mt Mary Road

We are happy to share with you that Mt Mary Road is finally under construction! Mt Mary Road is a major piece of infrastructure that will connect Eynesbury with Wyndham. The road will save 25 minutes from Eynesbury to Werribee.

This project has had many planning challenges and constraints; however, all is now resolved, and Winslow have formally been issued with possession of site. In the coming weeks, Winslow will establish their perimeter and stock proof fencing, signage, site sheds and preliminary works before the heavy machines start the bulk earthworks. The forecast program is for works to be completed by mid-2023.

Celebrating the sod-turning of Mt Mary Rd on Friday 29th July with Melton Council, Steve McGhie MP, Winslow Constructors and Resimax Group.



## Stage Construction

Stage 6 civil works are now complete with stages 6A – 6C registered. Statement of compliance is being sought on stages 6D – 6F.

Stages 5C and 13A are progressing well with road works now commenced. Target completion is the end of the calendar year.





Artist Impression.

## Hotel & Wellness Centre

We are thrilled to reveal that part of our vision for Eynesbury is to develop a luxury hotel and wellness centre. The hotel is planned to include 60 rooms, a 300-person capacity conference centre and drum roll... a European style day spa and wellness centre. The architectural design, proposed finishes, and amenities this offers will no doubt elevate Eynesbury to a new level of premium.

The proposed location is on Eynesbury Road immediately adjacent to the Heritage Homestead. The site is generous in size and takes advantage of view lines over the 10th hole and Grey Box Forest. The site is also free of native vegetation and significant heritage considerations in contrast to the development plan which nominates the hotel to be co-located with the homestead.

Techne is the lead architect on the project, they have designed the hotel with natural building elements in mind such as a stone and timber. The building surrounds and carpark will be heavily landscaped with native species of shrubs and trees to blend in with the surrounding landscape.

Whilst a planning application has been lodged, there are many milestones ahead, however we look forward to sharing more about this exciting proposal with you. In the meantime, please feel welcome to reach out to Ebbie Hungerford if you have questions or to share your thoughts.

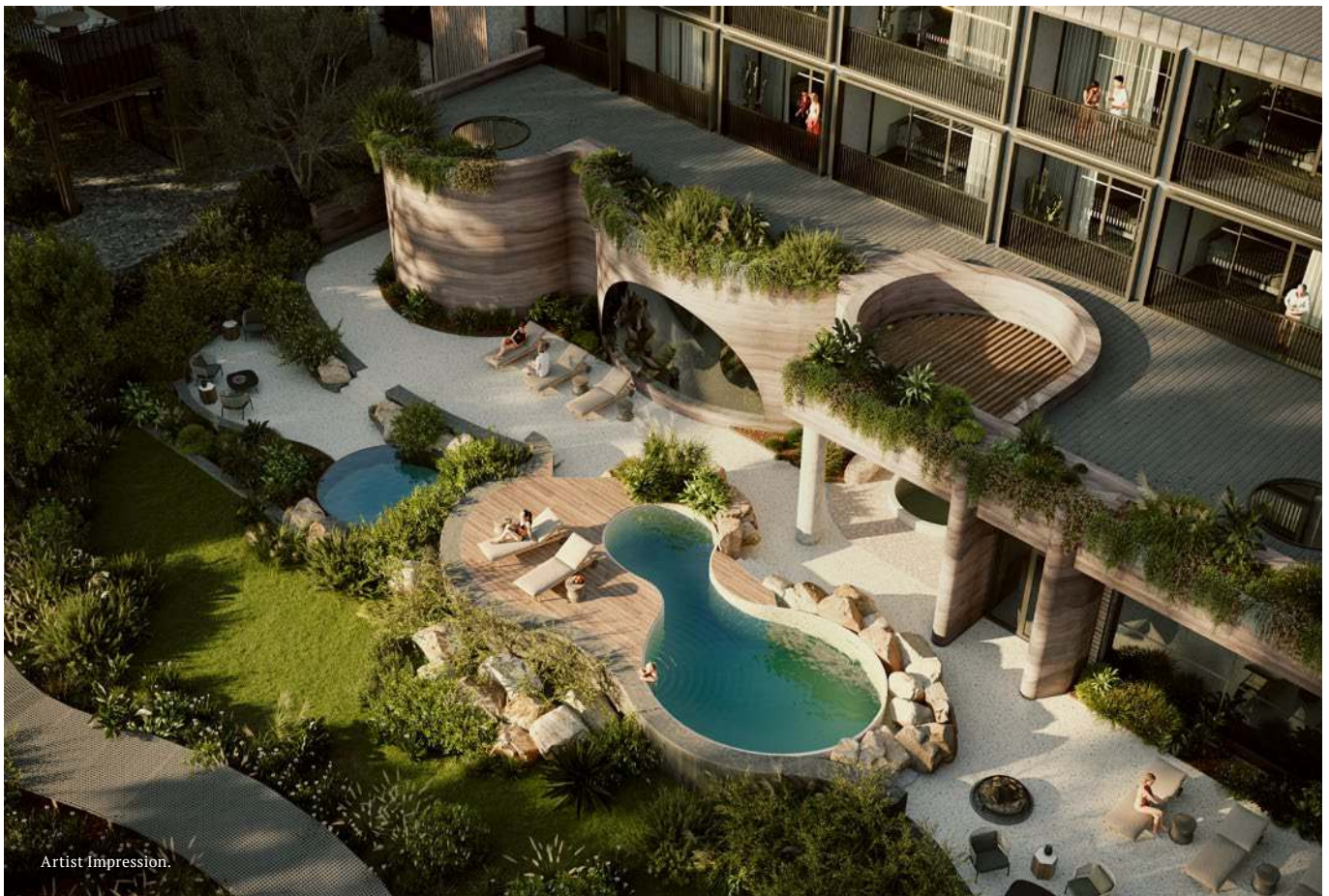

Artist Impression.



## Proposed Secondary School

We know education is one of the most important elements in building a new community, so it comes as no surprise that many residents have expressed the desire for a secondary school at Eynesbury. In response, we will be seeking expressions of interest from private operators that are looking to establish a new campus in the west.

We're focused on finding the right partner that is motivated to establish a new school sooner rather than later. At this stage we are focussed on finding the right partner and if successful we can start planning location and the finer details.







Artist Impression.

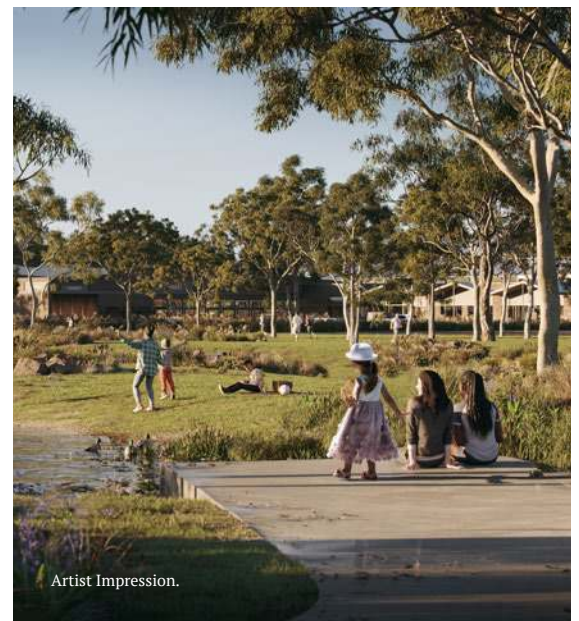

Artist Impression.

## Wetlands

The future at Eynesbury continues to embody a walkable outdoors lifestyle. The introduction of extensive scenic wetlands are set to provide residents with a premium network of open spaces, places to gather, fitness nodes and walking/cycling tracks.

The wetlands under construction are nearing completion. The remaining works include topsoiling and completion of the path network. It is expected that civil construction will be finished in September. Resimax Group has also just awarded the landscaping contract to Australian Ecosystems (specialist contractors in waterway and wetland landscaping). The plants will be contract grown offsite and installed when the conditions are ideal. We can't wait for these vast open spaces to be landscaped and looking great!





# ANNOUNCEMENTS

## FREE FOR ALL EYNESBURIANS YOUR BUS HAS ARRIVED



**TIMETABLE**  
EXCLUDING PUBLIC HOLIDAYS. SCHOOL LOOP DURING VIC SCHOOL TERMS ONLY.

### WEEKDAYS

	AM		PM
● EYNESBURY PROSHOP	DEPARTS 6:45	● CATHOLIC REGIONAL COLLEGE (BULMANS RD)	DEPARTS 3:40
● EYNESBURY EARLY LEARNING* (OPP EAGLEHAWK BLVD)	DEPARTS 6:48	● HEATHDALE CHRISTIAN COLLEGE (PTV STOP CENTENARY AV, ARAWATA PDE)	DEPARTS 3:50
● MELTON STATION (OPP 33 STAUGHTON ST)	DEPARTS 7:15	● MELTON CHRISTIAN COLLEGE (PTV STOP BEFORE SPRINGBANK WAY)	DEPARTS 4:00
● CRN BENDIGO DR & RUSHWORTH AVE	DEPARTS 7:40	● STAUGHTON COLLEGE (PTV STOP AT 39 WILSON RD)	DEPARTS 4:17
● RUSHWORTH AVE (OPP 33 LAURISTON DR)	DEPARTS 7:43	● EYNESBURY PROSHOP	DEPARTS 4:25
● 697 EYNESBURY RD	DEPARTS 7:46	● CRN BENDIGO DR & RUSHWORTH AVE	DEPARTS 4:35
● CRN EYNESBURY RD & TRENTHAM AVE	DEPARTS 7:48	● RUSHWORTH AVE (OPP 33 LAURISTON DR)	DEPARTS 4:41
● EYNESBURY PROSHOP	DEPARTS 7:51	● 697 EYNESBURY RD	DEPARTS 4:43
● STAUGHTON COLLEGE (PTV STOP AT 39 WILSON RD)	DEPARTS 8:05	● CRN EYNESBURY RD & TRENTHAM AVE	DEPARTS 4:45
● MELTON STATION (OPP 33 STAUGHTON ST)	DEPARTS 8:10	● MELTON STATION (OPP 33 STAUGHTON ST)	DEPARTS 4:57
● MELTON CHRISTIAN COLLEGE	DEPARTS 8:15	● EYNESBURY PROSHOP	DEPARTS 5:17
● CATHOLIC REGIONAL COLLEGE (BULMANS RD)	DEPARTS 8:20	● EYNESBURY EARLY LEARNING* (OPP EAGLEHAWK BLVD)	DEPARTS 5:21
● HEATHDALE CHRISTIAN COLLEGE (PTV STOP CENTENARY AV, ARAWATA PDE)	ARRIVES 8:27	● MELTON STATION (OPP 33 STAUGHTON ST)	DEPARTS 5:47
		● EYNESBURY PROSHOP	DEPARTS 6:12
		● EYNESBURY EARLY LEARNING* (OPP EAGLEHAWK BLVD)	ARRIVES 6:17

### SATURDAY

	AM		PM
● EYNESBURY PROSHOP	DEPARTS 11:35	● WOODGROVE SHOPPING CTR	DEPARTS 3:55
● EYNESBURY EARLY LEARNING*	DEPARTS 11:40	● MELTON STATION	DEPARTS 4:05
● OPALIA SHOPPING CTR	DEPARTS 11:55	● OPALIA SHOPPING CTR	DEPARTS 4:15
● MELTON STATION	DEPARTS 12:00	● EYNESBURY PROSHOP	DEPARTS 4:25
● WOODGROVE SHOPPING CTR	ARRIVES 12:10	● EYNESBURY EARLY LEARNING*	DEPARTS 4:30
		● MELTON STATION	ARRIVES 4:50

\*STOPPING ON EYNESBURY RD

FOR MORE INFORMATION VISIT:  
**EYNESBURY.COM.AU**



## Eynesbury Bus

Eynesbury Bus timetable update | Melton schools added!

Our Community Development Manager has some exciting news! Early this year, she was contacted about the transport issue experienced by a large number of families getting their teens to local high schools. Unfortunately, with so many aspects and authorities, a PTV service wasn't happening anytime soon.

Resimax Group has spent the last 4+ months liaising with various authorities, and are excited to share that the Eynesbury Bus has added schools to its service (AM and PM) from the beginning of Term 3. The schools are Staughton College, Melton Christian College, Catholic Regional College and Heathdale Christian College. View the new timetable.

This service has been added to accommodate for students who weren't able to secure a spot on the current school services. The new timetable with the added times and stops has been scheduled to fit in with the various authorities and may not be suitable for all; we apologise for any inconvenience in the change of times and stops.

We are continually working in the background with residents to advocate for a full PTV service. For more information or to express your interest, please email; [ebbie@eynesbury.com.au](mailto:ebbie@eynesbury.com.au).







## Eynesbury Eagles Cricket Club

### Celebrating 10 years of the Eynesbury Cricket Club

With the cricket season fast approaching, the Eynesbury Cricket Club has appointed local resident Tristian Francis as the new president for the 2022/2023 season. Tristan has had various roles within the club including Junior Coordinator, General Committee member, Woolworth blasters coordinator, Senior coach and is currently the first Team Captain.



I'm passionate about the local community and I'm excited for the upcoming season which will be the club's 10th year. When we moved into Eynesbury in 2015, the Cricket Club was a great way to meet local residents that carried the same interests in sport. With the development of the Eynesbury Sporting Precinct, it has given our family a great environment to build lifelong friends and enjoy the sporting social life without travelling too far from home. My wife Mary coaches the junior girl's netball, and our 4 kids are involved in either cricket or netball. This year, we have some great local additions to the committee with my father, Leigh Francis, taking on the role as Secretary, and Trent Wemyss joining to run social events. Leigh is one of the longer serving residents of Eynesbury, and has had past roles on the OC and Environmental Group. Jason Davis continues his support with the role of Club Treasurer and Junior Coordinator. We are all committed to offering the community a great way to meet new people, providing a fun & social environment and developing the skills of both junior and senior cricketers. – Tristan

If you or your children are interested in joining our cricket club, please register online at <https://play.cricket.com.au> and search for Eynesbury Cricket Club.

The Eynesbury Cricket Club caters to boys and girls in mixed teams of all abilities. If you'd like to be involved in coaching or team management, please contact us; [info@eynesburyeaglescc.com.au](mailto:info@eynesburyeaglescc.com.au).

We're accepting players for under 11, 13, 15, 17 and senior cricket. Social memberships are also available.





## Eynesbury Kindergarten

### Wellbeing Garden | Funded by Health Promotion Health and Wellbeing Grants – Western Health

Our service values the importance of teaching children and families about the importance of nutrition, promoting wellbeing and advocating for meaningful reconciliation with Aboriginal and Torres Strait Islander Peoples.

We also value the importance of creative arts, and recognize the benefits that art therapy projects can have on a child's holistic wellbeing. Art therapy is a form of expressive therapy that uses the creative process of making art to improve physical, mental, and emotional well-being. It allows children an opportunity to express and understand emotions through creative processes.

Our plan is threefold – we propose to:

- Create a wellbeing garden that incorporates art projects that are created in collaboration with our children, our community and Wadawurrung people.
- The growing of bush tucker, fresh fruit and vegetables to share with community.
- A cooking program that promotes the use of fresh produce and encourages families to participate.
- We propose to invite our community to work collaboratively with us (subject to covid restrictions), as we plan and create a range of mosaic art installations to decorate large pots and a wall in our garden area.
- We propose to partner with Val Turner (Community Engagement worker from Bunnings Melton) to donate materials for our art installations on large pots and a wall mural.
- We will be guided by the “Paleert Tjaara Dja” (Let's make country good together plan 2020 – 2030) when deciding what plants to add to our garden (Wadawurrung Traditional Owners Corporation).

Our educator Danielle is a trained chef, with an interest in children's nutrition and will plan a range of cooking experiences guided by the Australian Dietary Guidelines for Children. Danielle plans to incorporate the produce that we grow and educate children & families about nutrition. We have recently signed up as members of the ‘Vic Kids Eat Well Program’ and will utilise this program in our learning curriculums.

We know from the ‘Vic Kids Eat Well Program’ that by making healthier foods and drinks available for all children can help meet the recommendations in the Victorian Department of Health's Healthy Choices guidelines.

It is important to surround children with delicious, healthy foods and drinks, wherever they spend their time and giving them opportunities to utilise the healthy foods that they grow will encourage and support them to eat well.

Our service does not have an oven or alternative means of cooking inbuilt onsite. We propose to purchase a convection oven and place it on a trolley so that it can be moved between groups and utilized in our curriculum.

We plan to share excess produce with families and the community, with the possibility of creating a cookbook with recipes to share with our learning community. The garden will be created down the side of our building so that the community have access to it through an open gate on weekends and over the holiday period.







It is important to surround children with delicious, healthy foods and drinks, wherever they spend their time and giving them opportunities to utilise the healthy foods that they grow will encourage and support them to eat well.







## Eynesbury Dance Scene

Term 3 classes of Eynesbury Dance Scene are in full swing! We're currently preparing for our end of year concert, organising roles for the mini production of 'Frozen', which the Musical Theatre students have been auditioning for and purchasing beautiful costumes.

Due to the winter weather, we haven't been able to perform as much as we had hoped – however, we are very excited for our upcoming performances at Sutton House Mackenzie Aged Care Group in Melton South at the end of August, the Eynesbury Market in September, our professional photos in November and our end of year concert in December!

The end of the year is a very busy time for us; nevertheless, enrolments are still open in our Junior and Senior Musical Theatre classes (ages 5 and up), Jazz and Ballet classes (from ages 2 and up). Please contact Eynesbury Dance Scene's principal, Gemma Pentony, if you are interested in receiving more information or arranging a trial class for your child; [eyn.dance.scene@gmail.com](mailto:eyn.dance.scene@gmail.com).

Like us on Facebook at [Facebook.com/Eyn.Dance.Scene](https://www.facebook.com/Eyn.Dance.Scene).





## How I Met the Local Teen Entrepreneur

We love celebrating our community and sharing all things local! Our local business for this month is Stella's Granola Crunch.

- Owner and creator of Stella's Granola Crunch, Stella Blaikie has been an Eynesbury resident for over 9 years with her parents and brother.
- After leaving Queensland, Stella's family discovered and instantly fell in love with Eynesbury!
- Stella's business makes homemade fresh granola - made to order!
- Stella loves Eynesbury because it's a nice area and has a golf course. Plus, all the nature makes her feel safe.
- Business for Stella is going well, because in Eynesbury everyone knows everyone which creates great word of mouth.
- Each bag of Granola is made to order in two amazing flavours; choc nut and maple drizzle.
- What's on for 2022? Stella is most excited for a full year without lockdowns, growing her business with local support, and hopes to have a shopping centre and gym built soon.

Do you want to be our next local business feature? Get in touch with us!

*Stella's Granola Crunch is now available at The General!*





## Eynesbury Early Education

### **Welcome Eynesbury Early Education.**

We are a 110-place service that caters for children from 6 weeks to 6 years. We are open 6.30am to 6.30pm, Monday to Friday. At Eynesbury Early Education, we are proud to be offering a curriculum that not only caters to the interests of the children through play, but also a program that is engaging and builds success for life! We aim to provide a personal and happy family atmosphere where parents, community members and organisations will feel welcome and encouraged to participate whenever possible to bridge the gap between home, the centre, and the community.

We have various incursion and excursions throughout our program, such as weekly music classes and weekly sport classes. We offer a range of different incursions aimed at expanding children's knowledge in areas they are interested in throughout the year.

We offer a 3-year-old and a 4-year-old government funded kindergarten program. Our 4-year-old kindergarten children attended weekly Bush Kinder excursions in the Grey Box Forest. Bush Kinder provides children with uninterrupted play in the bush using what nature has provided as learning materials. The children have the opportunity to jump in puddles, balance along fallen trees, climb trees, get involved in dramatic play, finding insects, and drawing with sticks in the ground. The opportunities for children to construct their own learning is endless, it also gives our educators a different aspect of intentional teaching.





### Pre-Kinder Care

As our toddlers' transition to our pre-kinder room, they continue to use hands on exploration and social interaction to learn about their expanding world. Our pre-kinder room caters for children between the ages of 2½ to 3 years old. Children become more independent and are consistently encouraged by our educators to practice independence skills, with help when needed of course! Self-feeding, dressing, hygiene, and toileting are all self-help skills that we practice every day in our pre-kinder room. Communication is a big focus for us, as children learn to express themselves and converse with their peers. Our curriculum for our pre-kinder children is designed to adapt to each child's individual age and stage.



### 3-year-old Kindergarten

Our 3-year-old government funded kinder program provides an opportunity for your child to engage in a fun and social education program, in a play space designed to enhance learning and overall development with a bachelor qualified kindergarten teacher.

Our 3-year-old kinder children have ample space and opportunity to climb, build, ride, balance and investigate in their outdoor yard. Activities are limited only by your child's imagination. Choices include block building, painting, drawing, play-doh, clay moulding, and texture play – just to name a few!

Creativity is stimulated by dramatic play, dress-ups and more! To encourage improvement of both fine and gross motor skills, we provide puzzles, water play and movement, along with singing, dancing, and games. Group times facilitate intentional learning and calm transition times throughout each day. Our 3-year-old kinder children have weekly music and sports incursions.



### Nursery Care

Our nursery room is a loving and caring environment for your children to grow and learn, and we offer a separate sleeping room for the children's sleep time away from the noise of the room. We welcome mothers who are still breast feeding to come in and enjoy one of our quiet spaces to feed and bond with their baby.

### Toddler Care

The move from nursery to our toddler 1 room is an exciting time for everyone! The children begin to explore their environment with access to an indoor/outdoor program, this enables the children to make choices over their play. Imagination is boundless at this age – and to keep up, we provide a never-ending (and ever-changing) variety of activities including art, imaginary play, outdoor adventure, singing, dancing, and more. We encourage the children's self-help skills, such as self-feeding and self-serving at mealtimes.

### 4-year-old Kindergarten

Our four-year-old government funded kindergarten program is a safe environment to prepare our young people for school, including helping children understand and cope with their big emotions, equipping children with the confidence to initiate and navigate friendships, and nurturing self-confidence and community awareness. Our kinder children participate in weekly bush kinder excursions in our local Grey Box Forest. The children explore the natural environment giving them a different aspect of learning. We offer different incursions aimed at expanding their knowledge in areas they are interested in.

Our kinder aged children can enjoy their own outdoor yard where they can investigate and explore their environment, taking part in climbing, building, creating, digging, riding, and balancing. Throughout the year, our kinder teacher and educators incorporate your child's interests into our program to help create a fun, comfortable and exciting space for your child to learn, grow and develop. There is a strong focus on school readiness and our qualified kindergarten teacher will work with you and your family to ensure your child flourishes!



## Eynesbury Tennis Club

The Eynesbury Tennis Club is hosting an official doubles tournament on Saturday 17th September. Please come down to the courts to cheer on our members!

We're excited to be continuing to grow our tennis club and to have an ATP Tennis coach, Robin Kumar from iTennis Coaching Academy. You can contact Robin for coaching, cardio tennis, group and individual sessions through our Facebook page and website; [www.play.tennis.com.au/EynseburyTennisClub](http://www.play.tennis.com.au/EynseburyTennisClub).

We're having our Open Day at the courts on Saturday 6th August, we look forward to welcoming the community with a BBQ and fun court activities.

The Eynesbury Tennis Club will be participating in our first inter-club competition from Wednesday 5th October with 5 other local clubs. This is a first for tennis in the area and we are looking forward to bringing home our first club trophy.

Lastly, our club is holding a Father's Day raffle to raise funds and purchase marquees. You can purchase tickets at the Eynesbury Golf Proshop for \$2 each. Prizes consist of 2x 2-night stays at Mantra on View Surfers Paradise, 2x Virgin Australia vouchers of \$200 each, an \$100 voucher for Ms Peacock Restaurant & Bar, an \$50 voucher for Ms Peacock Restaurant & Bar and 4x 30-minute coaching sessions with our coach.

We are still looking for sponsorships; please reach out to Matt Osborne if you're interested: [eynesburytennisclub@gmail.com](mailto:eynesburytennisclub@gmail.com).









## Eynesbury Eagles Football Netball Club

On Friday 29th July, the 18's club (senior team) defeated Wallan and advanced to the Grand Final! Thanks to First National Real Estate for putting on the longest kick competition at half time, which was a huge success!

The Grand Final was played on Friday 5th August against At Albans, the boys played well but couldn't walk away with the win. The presentation night will be held on Saturday 8th October – save the date!

On Saturday 23rd July we held the club's first ever mid-year ball, it was a great night! Thank you so much to Amanda from Proud Designs for decorating the venue, and thank you to Resimax Group for a great event at the Marquee once again.

In late June, our senior netball team played off in the grand final and narrowly went down. Well done on a magnificent season!







After a fantastic season by all our junior football and netball teams, we will be holding the presentation night on Friday 9th September at Tabcorp Park. Tickets can be purchased through our club's website. Well done to all players this year who competed strongly in the first full season since 2019. A special congratulations to the under 11's netballers, who made it to the finals for the first time!

On Friday 22nd July we had a very special guest play for the 18's... an All Australian, 2x premiership player and best & fairest, Corey McKernan. The team had a massive win against Bacchus Marsh! A special thanks to Brad from Werribee Mitsubishi for inviting Corey down.

Thank you to all supporters, players, volunteers, and sponsors for a fantastic season. A big thank you to our major sponsors, First National Real Estate and Werribee Mitsubishi for their significant contributions throughout the year, and to all of our sponsors who can be found on the banners around the ground and on our website and Facebook page.

If you would like to become involved in the Eynesbury Eagles Football Netball Club as a participant, please reach out via our Facebook page and message us if you have any questions.

Teams that need to be filled next year include both football and netball, from Auskick and Net Set Go through to under 9's, 11's, 13's, 15's, 17's and senior teams.

If you'd like to become involved as a sponsor or volunteer, please contact us via Facebook. We are always open to more support, and we appreciate it; every small part plays a big role in getting our teams on the field every week!

See you all in 2023. Go Eagles!



## Eynesbury Winter Festival

From the ice rink to themed markets and the Winter Solstice – our Winter Festival was a great success, thank you to everyone who attended!

We're already busy planning events for summer & another Winter Festival in 2023!









# WHAT'S ON



## Garage Trail

The Eynesbury Garage Sale Trail returns this October!

For more information, email our Community Development Manger, Ebbie: [ebbie@eynesbury.com.au](mailto:ebbie@eynesbury.com.au).



## Ladies Night featuring Magic Men

Get excited, Magic Men is returning to Eynesbury with the biggest & baddest crew!

Don't miss out, save the date in your calendar now: Friday 30th September, 7:15pm.

Join us for dinner at Ms Peacock before the show! Book now.

SCAN FOR  
TICKETS TO  
THE SHOW







## Eynesbury Golf Lessons Competition

### It's competition time!

Enter the Eynesbury Golf competition for your chance to win 12 months' worth of golf lessons!

The winner will receive 12 months' worth of lessons (monthly one-on-one lesson), practice schedule, progress reports and full access to our driving range facilities for 12 months.

Enter now! The competition is open from Monday 1st August to Wednesday 31st August.



SCAN TO ENTER



EYNESBURY

GOLF







# COMMUNITY NOTICE BOARD

Welcome to Eynesbury's Community Notice Board! Keeping you informed with what's happening locally, from community events, programs, and promoting local businesses.

If you'd like to share information on our notice board, email our Community Development Manager; [ebbie@eynesbury.com.au](mailto:ebbie@eynesbury.com.au).



**Sunday 14 AUGUST 2022\***  
*\* (In the same spot as the Eynesbury Market)*  
**Egg/Bacon Muffins & Coffee on site**

This is a great opportunity to clear out your cupboards  
 ... so load up that boot and join us

**QUESTIONS?**  
**CONNIE**  
**0468 671 920**

9am - 2.00pm



**Tickets \$10.00 per car**  
*(Must be purchased in advance)*

Use Link below or scan QR code above to buy tickets or call Connie

<https://www.rotaryeynesbury.com>

**BOOK YOUR SPOT ASAP - BEFORE THEY'RE ALL TAKEN**



**JOIN THE JUNIOR PARKRUN FAMILY**  
**WALK, JOG, RUN, VOLUNTEER**  
 or simply come and watch – it's up to you!

<p><b>FAMILY-FRIENDLY 2K EVENTS</b>          Every Sunday morning</p> <p><b>EVERYONE WELCOME</b>          Walk, jog, run, hop, skip or jump - It's up to you!</p> <p><b>HAVE FUN BEING ACTIVE</b>          Share high fives and big smiles!</p> <p><b>LEARN NEW SKILLS</b>          Kids can volunteer in lots of roles</p>	<p><b>FOR 4-14 YEAR OLDS</b>          Adults can join in with the kids too!</p> <p><b>FREE &amp; EASY TO TAKE PART</b>          No special kit needed - wear whatever you like</p> <p><b>MAKE FRIENDS</b>          Meet lots of new people</p> <p><b>FEEL HAPPY AND PROUD</b>          Try your best and celebrate your achievements</p>
---	--

*"We all do it together as a family. The volunteers are really nice, it's fun and you can walk if you want to!"*

Register at [parkrun.com.au](http://parkrun.com.au)  
 and head down to your local junior parkrun event!

**notes:**  
 Eynesbury Heritage Trail junior parkrun - Eynesbury Discovery Centre Carpark  
 Every Sunday 8am





# EYNESBURY TENNIS CLUB

## EYNESBURY TENNIS DOUBLES CUP



**Saturday 17 September at 8am**

**Eynesbury Recreational Reserve**

**1 Avoca st, Eynesbury VIC 3338**

Entry fee: \$30 per player

Register today: [bit.ly/3zTvW1p](https://bit.ly/3zTvW1p)

Prize money of \$1000 for the winners and \$500 for Runners-up.  
Doubles team can consist of mixed players.

Knock-out tournament with 1 set per match, first to 6 games and  
tie-breaker at 6 games all. Grand final will be best of 3 sets.

Hot and cold food available to purchase throughout the day,  
plus change rooms available with showers.





## VISIT OUR DISCOVERY & SALES CENTRE

479 Eynesbury Road, Eynesbury VIC 3338

Open 7 days 11am – 5pm

## CONTACT US

(03) 9971 0414

**EYNESBURY.COM.AU**

---

### Get in touch

**Ebbie Hungerford**  
Community Development Manager  
M 0407 532 276  
E [ebbie@eynesbury.com.au](mailto:ebbie@eynesbury.com.au)

**Resimax Group**  
Level 3, 2 Drewery Place  
Melbourne, Victoria 3000

**RESIMAX**  
GROUP