



LEGEND

- PROPOSED STAGE BOUNDARY
- PROPOSED KERB & CHANNEL
- FALL OF ALLOTMENT
- DIRECTION OF OVERLAND FLOW
- PROPOSED STORMWATER DRAINAGE
- PROPOSED SEWERAGE RETICULATION
- PROPOSED WATER RETICULATION
- PROPOSED RECYCLED WATER RETICULATION
- PROPOSED ELECTRICITY UNDER GROUND
- PROPOSED COMMUNICATIONS
- PROPOSED GAS RETICULATION
- PROPOSED DRAINAGE INLET
- PROPOSED CONCRETE FOOTPATH/DRIVEWAY
- PROPOSED GAS / CLASS A / POTABLE WATER HOUSE CONNECTION
- BOLLARD
- PROPOSED RIDGE LINE
- EXISTING STAGE BOUNDARY
- EXISTING STORMWATER DRAINAGE
- EXISTING SURFACE CONTOURS
- EXISTING SEWER RETICULATION
- EXISTING WATER RETICULATION
- EXISTING RECYCLED WATER RETICULATION
- EXISTING ELECTRICITY UNDER GROUND
- EXISTING COMMUNICATIONS
- EXISTING GAS RETICULATION
- EXISTING SWALE
- FUTURE STORMWATER DRAINAGE
- FUTURE SEWER RETICULATION
- EXISTING TREES TO BE RETAINED
- EXISTING TREES TO BE REMOVED
- TEMPORARY FENCE
- TEMPORARY SWALE
- MUNICIPAL BOUNDARY
- PALING FENCE

NOTES:

1. PROPOSED SURFACE LEVELS SHOWN ARE SUBJECT TO CHANGE UPON DETAILED DESIGN.
2. FUTURE SUPERLOT BOUNDARIES SHOWN FOR SERVICE LOCATIONS ONLY. TO BE CONFIRMED UNDER SEPARATE CONTRACT.
3. STAGE 22A TO BE CONSTRUCTED CONCURRENTLY WITH STAGE 22B, D, E & MMR03.

ROAD LAYOUT TABLE

ROAD NAME	ROAD CLASSIFICATION	RESERVE WIDTH (m)	ROAD WIDTH			KERB TYPE		VERGE WIDTH (m)	
			LIP TO LIP	INV TO INV	BACK TO BACK	NTH/WEST	STH/EAST	NTH/WEST	STH/EAST
GYMBOWEN AVENUE	CS1	20.00	10.70m	11.60m	11.90m	B3/IC	B3/IC	4.20	4.20
CHERRYPOOL CRESCENT (LOT 22066-22073)	AS1	16.00	6.40m	7.30m	7.60m	B2	B2	4.50	4.20
CHERRYPOOL CRESCENT (LOT 22087-22102)	AS1	14.50	6.40m	7.30m	7.60m	B2	B2	1.35	5.85
PATYAH STREET	AS1	14.50	6.40m	7.30m	7.60m	B2	B2	1.35	5.85
LAHARUM STREET (LOT 22047-50, 22063-66)	AS1	14.50	6.40m	7.30m	7.60m	B2	B2	1.35	5.85
GOROKE STREET	AS1	16.00	6.40m	7.30m	7.60m	B2	B2	4.50	4.20
LAHARUM STREET (LOT 22040-22044)	AS1	16.00	6.40m	7.30m	7.60m	B2	B2	4.50	4.20
ARAPILES STREET	AS1	16.00	6.40m	7.30m	7.60m	B2	B2	4.50	4.20

SERVICES OFFSET TABLE

ROAD NAME	GAS		WATER		RECYCLED WATER		ELECTRICITY		COMMUNICATIONS	
	SIDE	OFFSET (m)	SIDE	OFFSET (m)	SIDE	OFFSET (m)	SIDE	OFFSET (m)	SIDE	OFFSET (m)
GYMBOWEN AVENUE	SOUTH	2.10	SOUTH	3.50	SOUTH	2.70	NORTH	2.60	NORTH	1.80
CHERRYPOOL CRESCENT (LOT 22066-22073)	WEST	2.10	WEST	3.10	WEST	2.60	EAST	2.60	EAST	1.80
CHERRYPOOL CRESCENT (LOT 22087-22102)	SOUTH	2.35	SOUTH	3.25	SOUTH	2.80	SOUTH	4.15	SOUTH	1.85
GOROKE STREET	EAST	2.10	EAST	3.10	EAST	2.60	WEST	2.60	WEST	1.80
LAHARUM STREET (LOT 22040-22044)	EAST	2.10	EAST	3.10	EAST	2.60	WEST	2.60	WEST	1.80
LAHARUM STREET (LOT 22047-22066)	SOUTH	2.35	SOUTH	3.25	SOUTH	2.80	SOUTH	4.15	SOUTH	1.85
PATYAH STREET	SOUTH	2.35	SOUTH	3.25	SOUTH	2.80	SOUTH	4.15	SOUTH	1.85
ARAPILES STREET	WEST	2.10	WEST	3.10	WEST	2.60	EAST	2.60	EAST	1.80

Issue	Description	DR	CH	VE	Date
04	ISSUED TO CLIENT FOR REVIEW	CM	HA	IOC	29.09.22
03	DRIVEWAY, SERVICE LOCATIONS AND PLAN UPDATE	CL	SE	IOC	27.07.22
02	PLAN UPDATED, LOT 22055 EASEMENT ADDED	CM	SE	IOC	10.06.22
01	ISSUED TO CLIENT FOR REVIEW	CM	SE	IOC	31.05.22

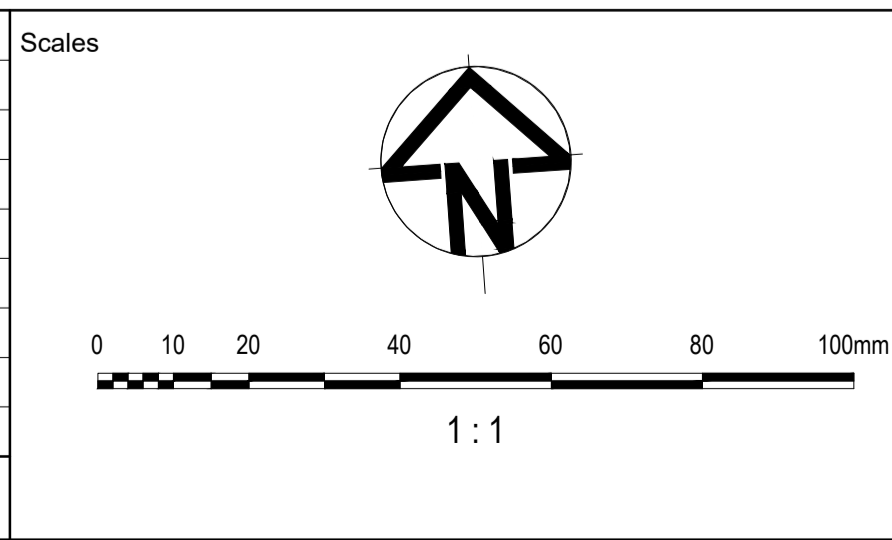

Planner

Client

Status

FOR APPROVAL
NOT TO BE USED FOR CONSTRUCTION

© Copyright reserved

Original Issue Signatures	
Drawn	C.MENEZ
Designed	H.ALAM
Project Manager	S.EISEL
Verified	L.O'CONNOR

Original Size: **A1**

Height Datum: **AHD**

Grid: **MGA**

Project

EYNESBURY TOWNSHIP
STAGE 22B
CITY OF MELTON

Title

SALES PLAN
SHEET 1

Arcadis Australia Pacific Pty Limited
Level 18, Queen & Collins Tower
376-390 Collins Street
Melbourne VIC 3000 Australia
ABN 76 104 485 289
Tel No: +61 3 8623 4000
www.arcadis.com

Project No. | Originator | Zone | Stage | Phase | Discipline | Type | Drawing No. | Issue

10029435 - AAP - AA22BFL - CV - DRG - 0810 - 04

ROAD LAYOUT TABLE									
ROAD NAME	ROAD CLASSIFICATION	RESERVE WIDTH (m)	ROAD WIDTH			KERB TYPE		VERGE WIDTH (m)	
			LIP TO LIP	INV TO INV	BACK TO BACK	NTH/WEST	STH/EAST	NTH/WEST	STH/EAST
GYMBOWEN AVENUE	CS1	20.00	10.70m	11.60m	11.90m	B3/C	B3/C	4.20	4.20
CHERRYPOOL CRESCENT (LOT 22066-22073)	AS1	16.00	6.40m	7.30m	7.60m	B2	B2	4.50	4.20
CHERRYPOOL CRESCENT (LOT 22087-22102)	AS1	14.50	6.40m	7.30m	7.60m	B2	B2	1.35	5.85
PATYAH STREET	AS1	14.50	6.40m	7.30m	7.60m	B2	B2	1.35	5.85
LAHARUM STREET (LOT 22047-50, 22063-66)	AS1	14.50	6.40m	7.30m	7.60m	B2	B2	1.35	5.85
GOROKE STREET	AS1	16.00	6.40m	7.30m	7.60m	B2	B2	4.50	4.20
LAHARUM STREET (LOT 22040-22044)	AS1	16.00	6.40m	7.30m	7.60m	B2	B2	4.50	4.20
ARAPILES STREET	AS1	16.00	6.40m	7.30m	7.60m	B2	B2	4.50	4.20

SERVICES OFFSET TABLE											
ROAD NAME	GAS		WATER		RECYCLED WATER		ELECTRICITY		COMMUNICATIONS		
	SIDE	OFFSET (m)	SIDE	OFFSET (m)	SIDE	OFFSET (m)	SIDE	OFFSET (m)	SIDE	OFFSET (m)	
GYMBOWEN AVENUE	SOUTH	2.10	SOUTH	3.50	SOUTH	2.70	NORTH	2.60	EAST	1.80	
CHERRYPOOL CRESCENT (LOT 22066-22073)	WEST	2.10	WEST	3.10	WEST	2.60	EAST	2.60	EAST	1.80	
CHERRYPOOL CRESCENT (LOT 22087-22102)	SOUTH	2.35	SOUTH	3.25	SOUTH	2.80	SOUTH	4.15	SOUTH	1.85	
GOROKE STREET	EAST	2.10	EAST	3.10	EAST	2.60	WEST	2.60	WEST	1.80	
LAHARUM STREET (LOT 22040-22044)	EAST	2.10	EAST	3.10	EAST	2.60	WEST	2.60	WEST	1.80	
LAHARUM STREET (LOT 22047-22066)	SOUTH	2.35	SOUTH	3.25	SOUTH	2.80	SOUTH	4.15	SOUTH	1.85	
PATYAH STREET	SOUTH	2.35	SOUTH	3.25	SOUTH	2.80	SOUTH	4.15	SOUTH	1.85	
ARAPILES STREET	WEST	2.10	WEST	3.10	WEST	2.60	EAST	2.60	EAST	1.80	

LEGEND	
	PROPOSED STAGE BOUNDARY
	PROPOSED KERB & CHANNEL
	FALL OF ALLOTMENT
	DIRECTION OF OVERLAND FLOW
	PROPOSED STORMWATER DRAINAGE
	PROPOSED SEWERAGE RETICULATION
	PROPOSED WATER RETICULATION
	PROPOSED RECYCLED WATER RETICULATION
	PROPOSED ELECTRICITY UNDER GROUND
	PROPOSED COMMUNICATIONS
	PROPOSED GAS RETICULATION
	PROPOSED DRAINAGE INLET
	PROPOSED CONCRETE FOOTPATH/DRIVEWAY
	PROPOSED GAS / CLASS A / POTABLE WATER HOUSE CONNECTION
	BOLLARD
	PROPOSED RIDGE LINE
	EXISTING STAGE BOUNDARY
	EXISTING STORMWATER DRAINAGE
	EXISTING SURFACE CONTOURS
	EXISTING SEWER RETICULATION
	EXISTING WATER RETICULATION
	EXISTING RECYCLED WATER RETICULATION
	EXISTING ELECTRICITY UNDER GROUND
	EXISTING COMMUNICATIONS
	EXISTING GAS RETICULATION
	EXISTING SWALE
	FUTURE STORMWATER DRAINAGE
	FUTURE SEWER RETICULATION
	EXISTING TREES TO BE RETAINED
	EXISTING TREES TO BE REMOVED
	TEMPORARY FENCE
	TEMPORARY SWALE
	MUNICIPAL BOUNDARY
	PALING FENCE

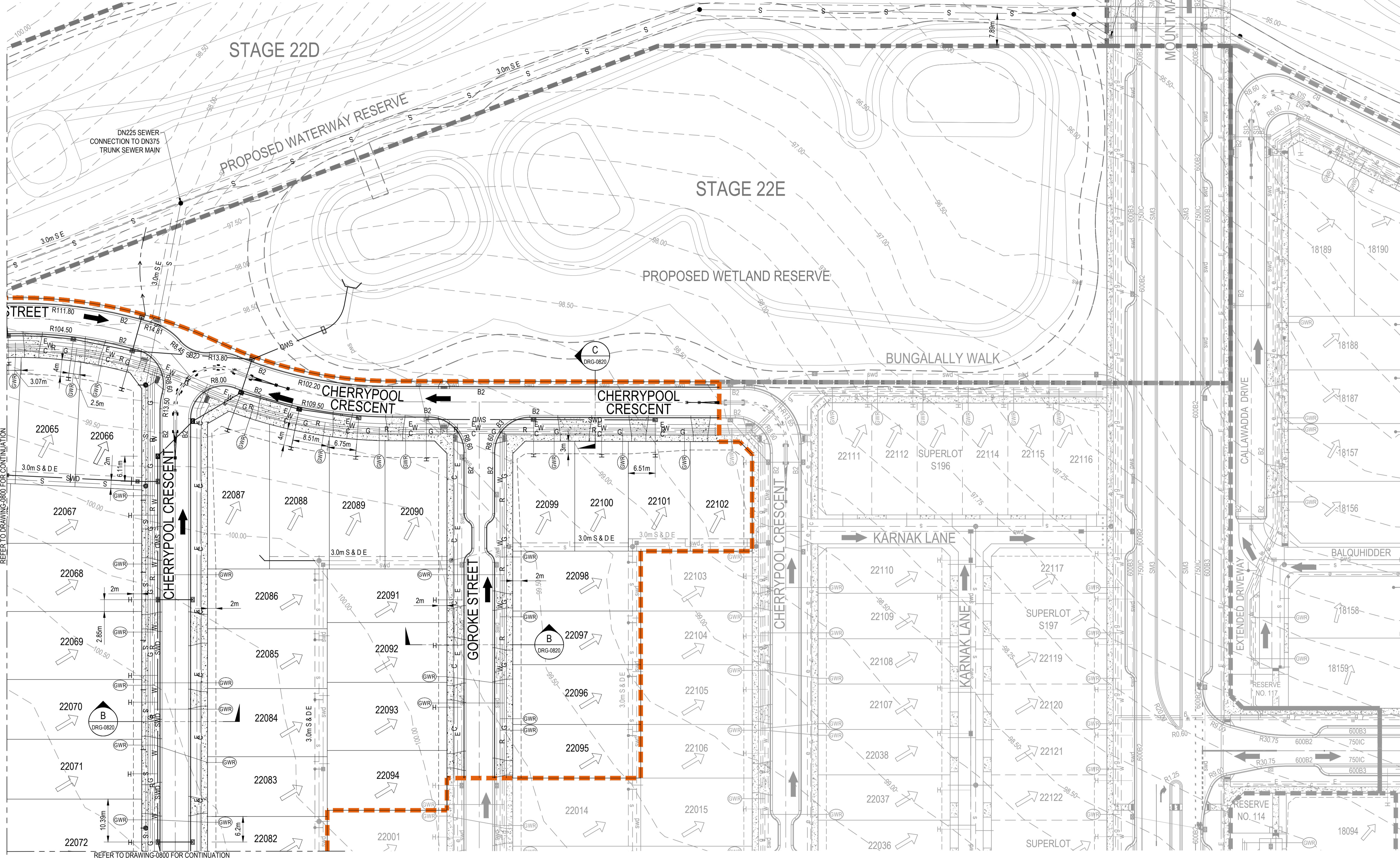

- NOTES:**
1. PROPOSED SURFACE LEVELS SHOWN ARE SUBJECT TO CHANGE UPON DETAILED DESIGN.
 2. FUTURE SUPERLOT BOUNDARIES SHOWN FOR SERVICE LOCATIONS ONLY. TO BE CONFIRMED UNDER SEPARATE CONTRACT.
 3. STAGE 22A TO BE CONSTRUCTED CONCURRENTLY WITH STAGE 22B, D, E & MMR03.

Issue	Description	DR	CH	VE	Date
04	ISSUED TO CLIENT FOR REVIEW	CM	HA	IOC	29.09.22
03	DRIVEWAY, SERVICE LOCATIONS AND PLAN UPDATE	CL	SE	IOC	27.07.22
02	PLAN UPDATED, LOT 22055 EASEMENT ADDED	CM	SE	IOC	10.06.22
01	ISSUED TO CLIENT FOR REVIEW	CM	SE	IOC	31.05.22

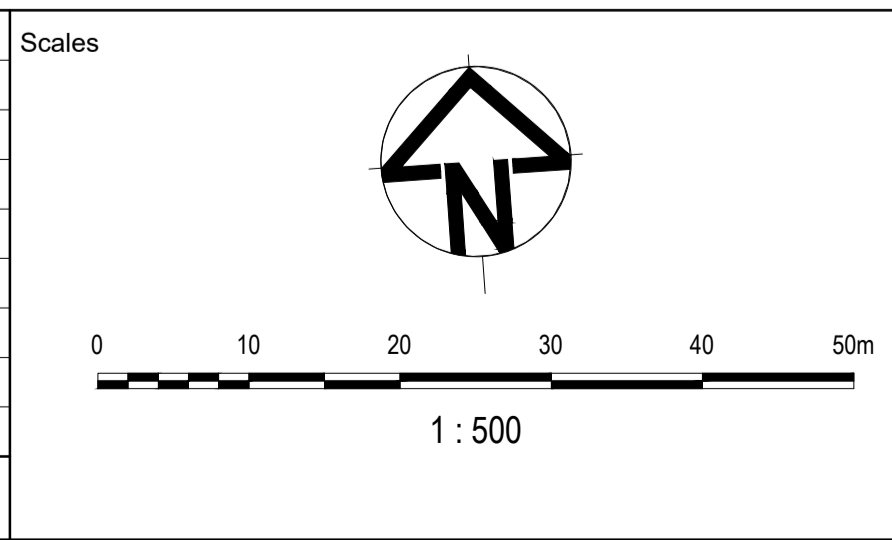

Planner

RobertsDay
planning.design.place

Client

Status

**FOR APPROVAL
NOT TO BE USED FOR CONSTRUCTION**

© Copyright reserved

Original Issue Signatures	
Drawn	C.MENEZ
Original Size	A1
Designed	H.ALAM
Height Datum	AHD
Project Manager	S.EISEL
Grid	MGA
Verified	L.O'CONNOR

Project

EYNEBURY TOWNSHIP
STAGE 22B
CITY OF MELTON

Title

SALES PLAN
SHEET 2

Arcadis Australia Pacific Pty Limited
Level 18, Queen & Collins Tower
376-390 Collins Street
Melbourne VIC 3000 Australia
ABN 76 104 485 289
Tel No: +61 3 8623 4000
www.arcadis.com

Project No. | Originator | Zone | Stage | Phase | Discipline | Type | Drawing No. | Issue

10029435 - AAP - AA22BFL - CV - DRG - 0811 - 04