

ROAD NAME	GAS		WATER		RECYCLED WATER		ELECTRICITY		TELECOMMS	
	SIDE	OFFSET (m)	SIDE	OFFSET (m)	SIDE	OFFSET (m)	SIDE	OFFSET (m)	SIDE	OFFSET (m)
COBRAM DRIVE (LOTS 5096-5098)	NORTH	1.80	NORTH	2.80	NORTH	2.30	SOUTH	0.90	SOUTH	0.40
COBRAM DRIVE (LOTS 5135-5146)	NORTH	1.80	NORTH	2.80	NORTH	2.30	SOUTH	2.60	SOUTH	1.80
BUNDALONG DRIVE (LOTS 5099-5104)	WEST	1.80	WEST	2.80	WEST	2.30	EAST	2.60	EAST	1.80
BUNDALONG DRIVE (LOTS 5106-5124)	SOUTH	1.80	SOUTH	2.80	SOUTH	2.30	NORTH	0.90	NORTH	0.40
DOOKIE ROAD	WEST	1.80	WEST	2.80	WEST	2.30	EAST	2.60	EAST	1.80
YALCA WAY	SOUTH	1.80	SOUTH	2.80	SOUTH	2.30	NORTH	0.90	NORTH	0.40

ROAD NAME	ROAD CLASSIFICATION	RESERVE WIDTH (m)	ROAD WIDTH			KERB TYPE		VERGE WIDTH(m)	
			LIP to LIP	INV to INV	BACK to BACK	NTHWEST	STHEAST	NTHWEST	STHEAST
COBRAM DRIVE (LOTS 5096-5098)	AS2	17.00	6.60	7.50	7.80	B2	B2	VARIES	VARIES
COBRAM DRIVE (LOTS 5135-5146)	AS2	16.00	6.40	7.30	7.60	B2	B2	4.35	4.35
BUNDALONG DRIVE (LOTS 5099-5104)	AS1	16.00	6.40	7.30	7.60	B2	B2	4.35	4.35
BUNDALONG DRIVE (LOTS 5106-5124)	AS1	14.00	6.40	7.30	7.60	B2	B2	4.35	2.35
DOOKIE ROAD	AS1	16.00	6.40	7.30	7.60	B2	B2	4.35	4.35
YALCA WAY	AL	14.00	6.00	-	-	-	-	-	-

LEGEND

- PROPOSED STAGE BOUNDARY
- PROPOSED DESIGN CONTOURS
- PROPOSED KERB & CHANNEL
- FALL OF ALLOTMENT
- DIRECTION OF OVERLAND FLOW
- PROPOSED STORMWATER DRAINAGE
- PROPOSED SEWERAGE RETICULATION
- PROPOSED WATER RETICULATION
- PROPOSED RECYCLED WATER RETICULATION
- PROPOSED ELECTRICITY UNDER GROUND
- PROPOSED COMMUNICATIONS
- PROPOSED GAS RETICULATION
- PROPOSED DRAINAGE INLET
- PROPOSED CONCRETE FOOTPATH/DRIVEWAY
- PROPOSED GAS / CLASS A / POTABLE WATER HOUSE CONNECTION
- BOLLARD
- FR98.86 FINISHED RIDGE LEVEL
- FS97.14 FINISHED SURFACE LEVEL
- 93.750 EXISTING SURFACE LEVEL
- PROPOSED RIDGE LINE
- CUT (> 0.3m)
- FILL (> 0.3m)
- EXISTING STAGE BOUNDARY
- EXISTING SURFACE CONTOURS
- EXISTING STORMWATER DRAINAGE
- EXISTING SEWER RETICULATION
- EXISTING WATER RETICULATION
- EXISTING RECYCLED WATER RETICULATION
- EXISTING ELECTRICITY UNDER GROUND
- EXISTING COMMUNICATIONS
- EXISTING GAS RETICULATION
- EXISTING SWALE
- FUTURE STORMWATER DRAINAGE
- FUTURE SEWER RETICULATION
- FUTURE GAS RETICULATION
- FUTURE WATER RETICULATION
- FUTURE RECYCLED WATER RETICULATION
- FUTURE ELECTRICITY UNDER GROUND
- FUTURE COMMUNICATION

NOTES:

- PROPOSED SURFACE LEVELS SHOWN ARE SUBJECT TO CHANGE UPON DETAILED DESIGN.
- DOWNSTREAM STAGE 13A TO BE CONSTRUCTED CONCURRENTLY TO PROVIDE DRAINAGE AND SEWER OUTFALLS.

REMOVE EXISTING CONCRETE EDGE STRIP, "NO ROAD" SIGN, AND MATCH NEATLY TO EXISTING CONSTRUCTION

Issue	Description	By	Ckd	PM	Date
01	ISSUED TO CLIENT FOR REVIEW	WB	ZS	JM	23.04.21

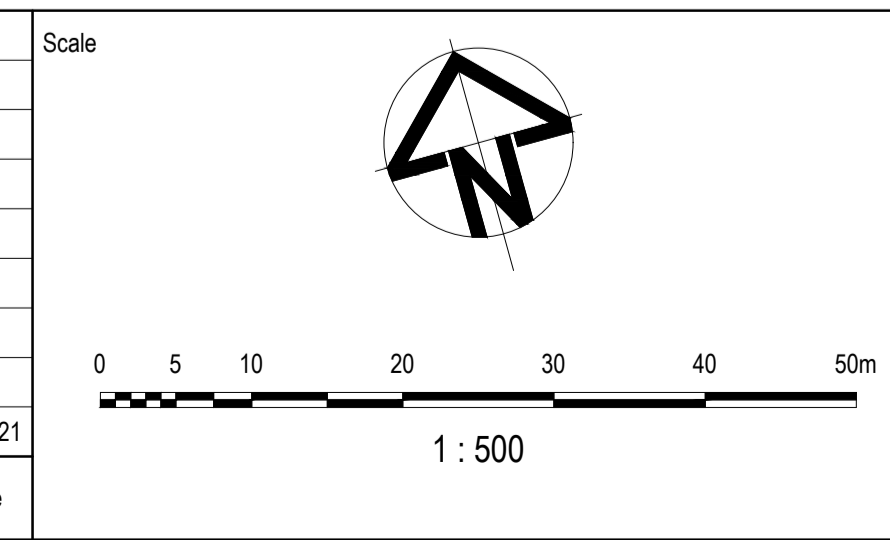

Planner

Client

Filename C-5C-801-10029435-FunctionalLayoutPlan.dwg

Status: FOR APPROVAL CONSTRUCTION SUBJECT TO APPROVAL

Checker: Z.STROGUSZ

Scales: 1:500

Original Size: A1

Height Datum: AHD

Grid: MGA

Original Issue Signatures: Drawn W.BUMAGAT, Designed K.ANGELES, Project Manager J.MUNRO

© Copyright reserved

Project: EYNESBURY TOWNSHIP STAGE 5C CITY OF MELTON

Title: FUNCTIONAL LAYOUT PLAN

Arcadis Australia Pacific Pty Limited
Level 32, 140 William Street
Melbourne VIC 3000
ABN 76 104 485 289
Tel No: +61 3 8623 4000
www.arcadis.com

Drawing No. C-5C-801 Project No. 10029435 Issue 01

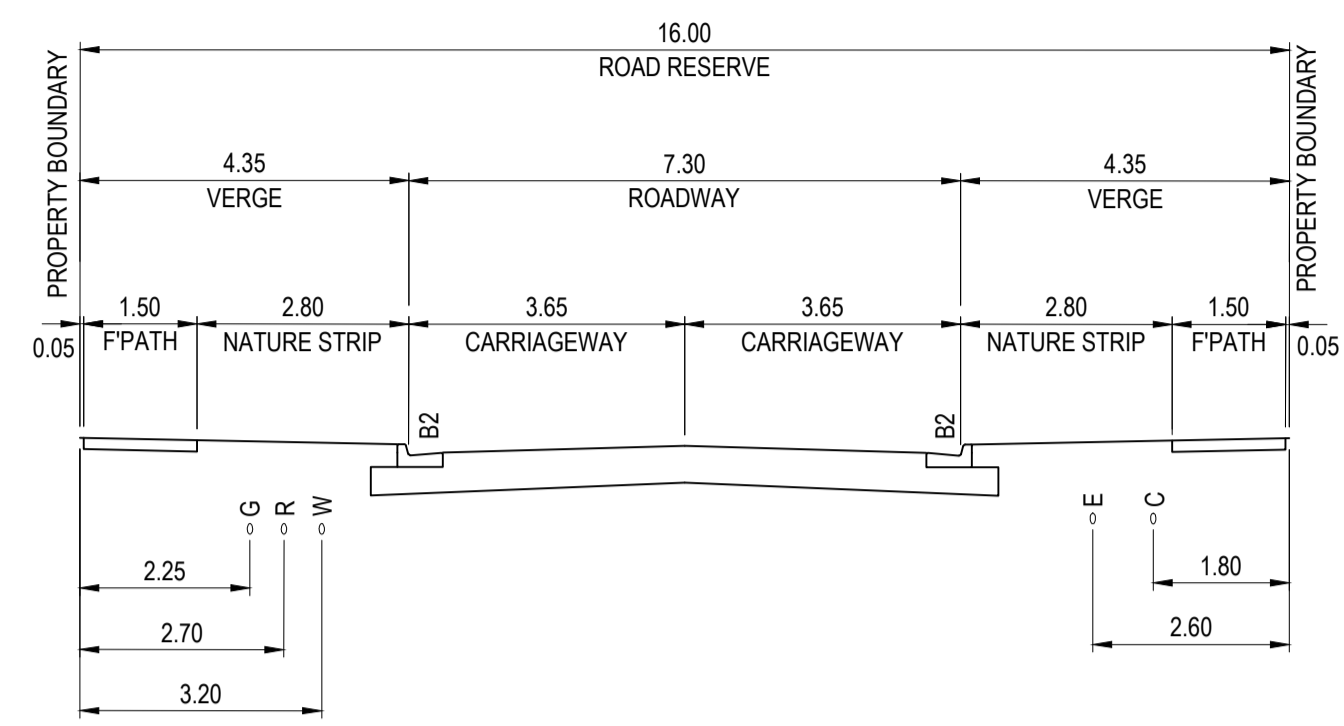

16.00m ROAD RESERVE
COBRAM DRIVE (LOT 5135-5146)
 TYPICAL SECTION - A

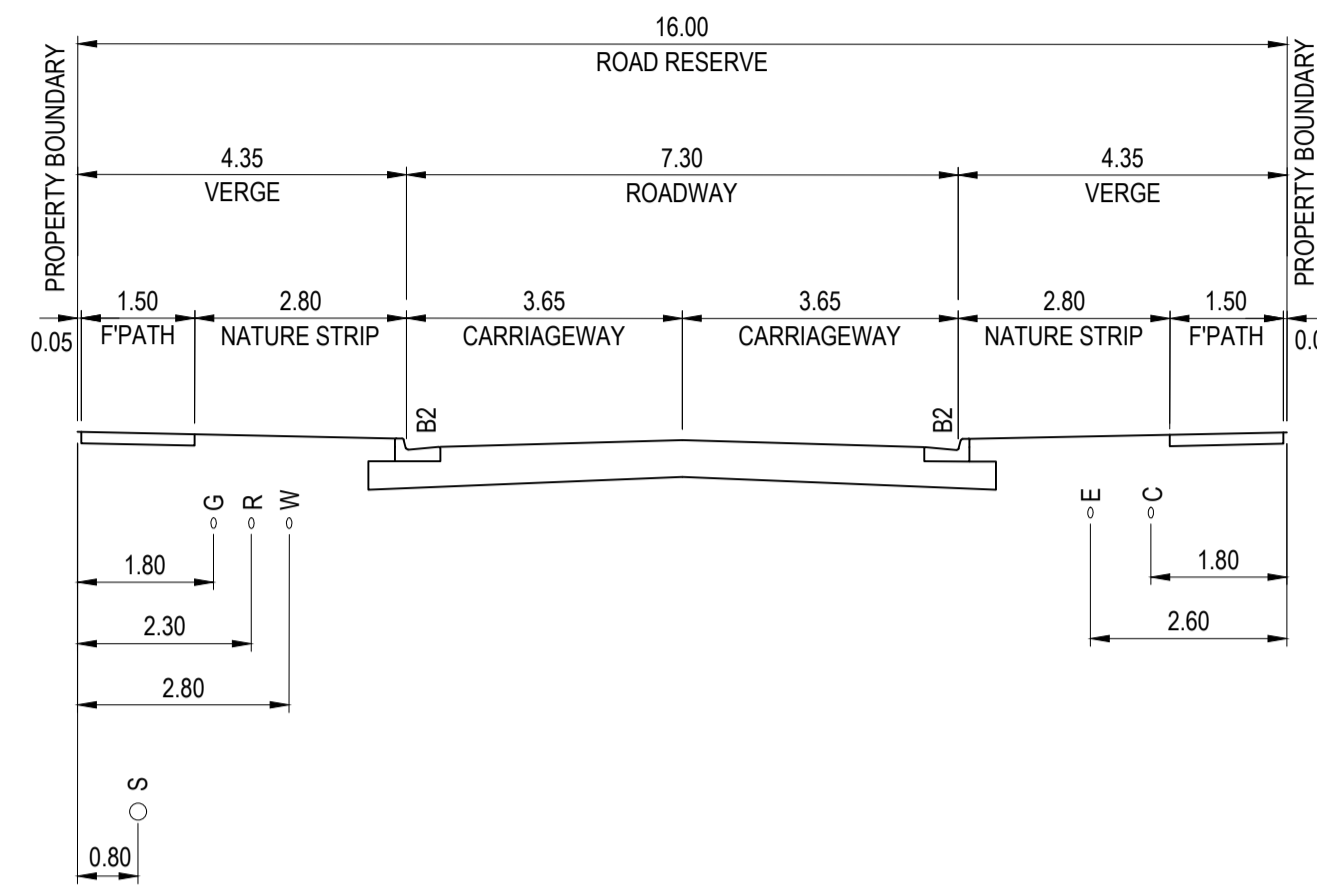

16.00m ROAD RESERVE
DOOKIE ROAD, BUNDALONG DRIVE (LOT 5099-5104)
 TYPICAL SECTION - B

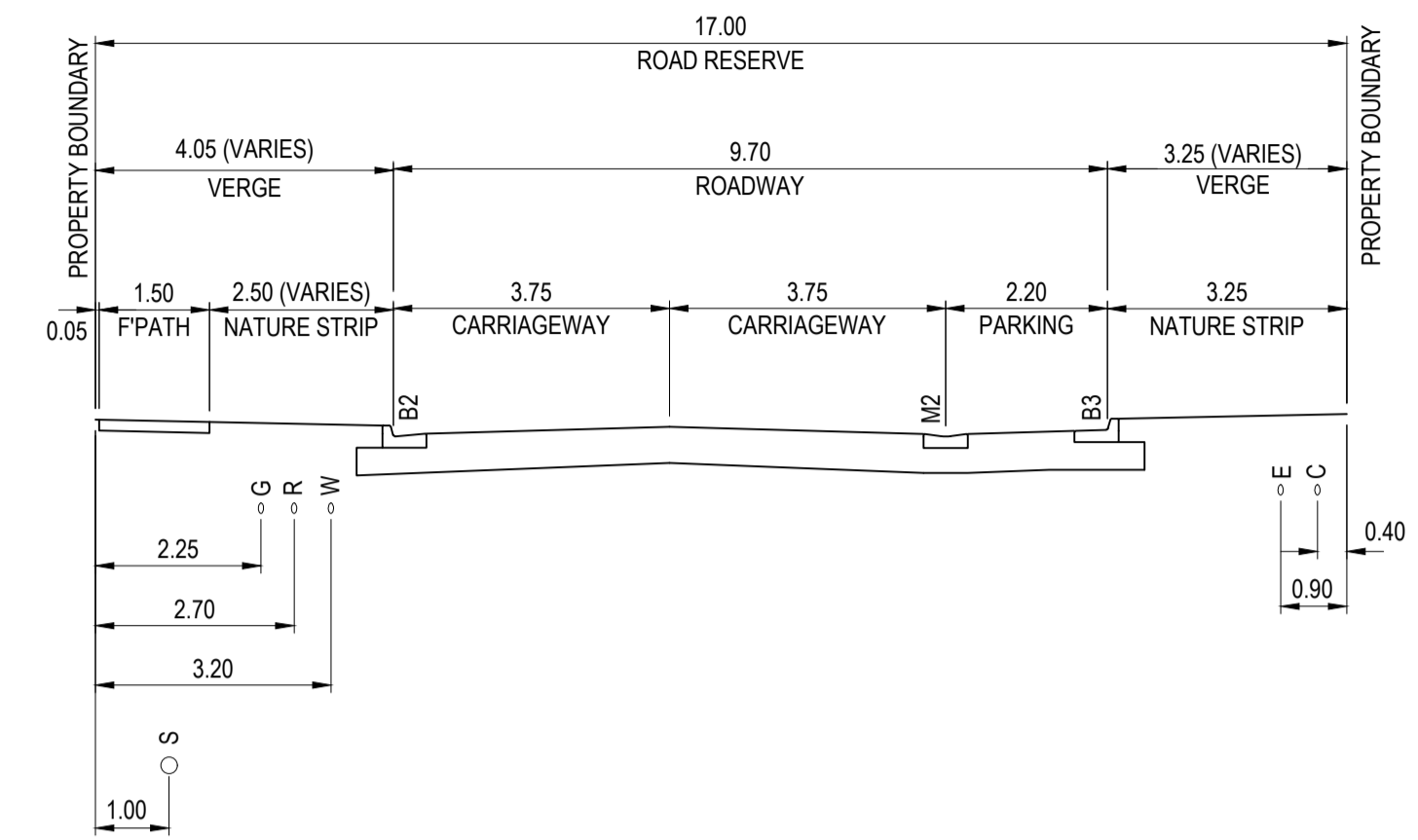

17.00m ROAD RESERVE
COBRAM DRIVE (LOT 5096-5098)
 TYPICAL SECTION - C

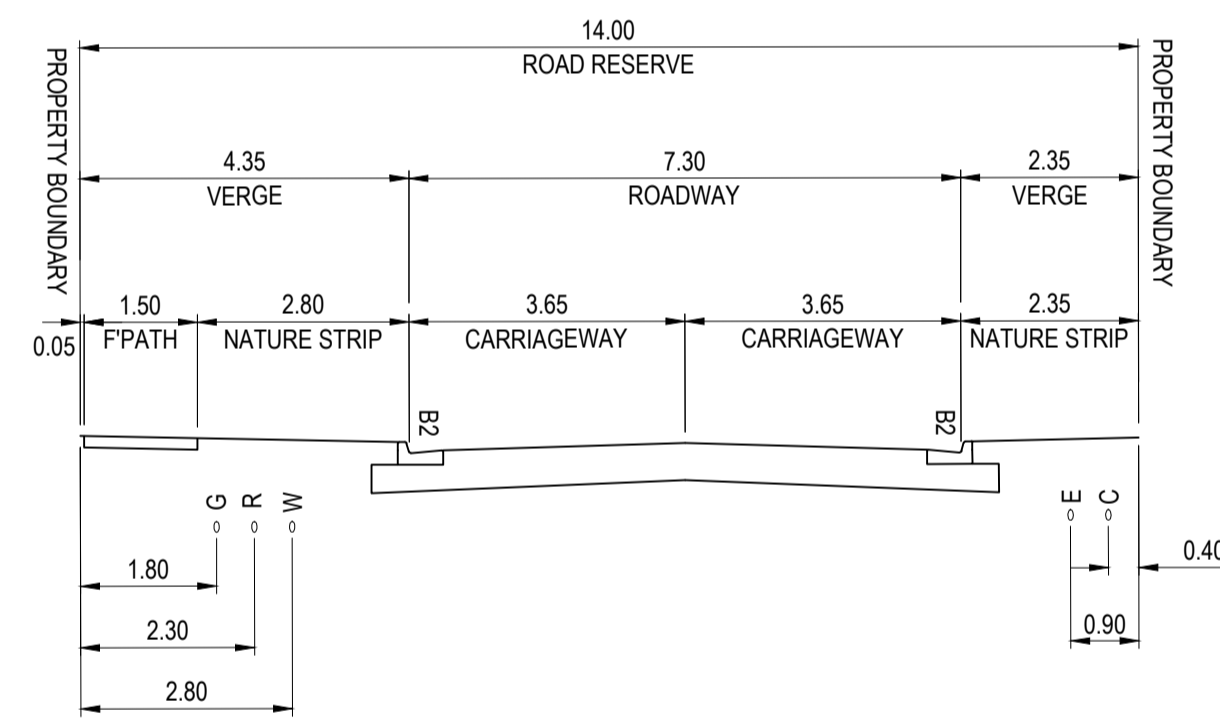

16.00m ROAD RESERVE
BUNDALONG DRIVE - TYPICAL SECTION - D

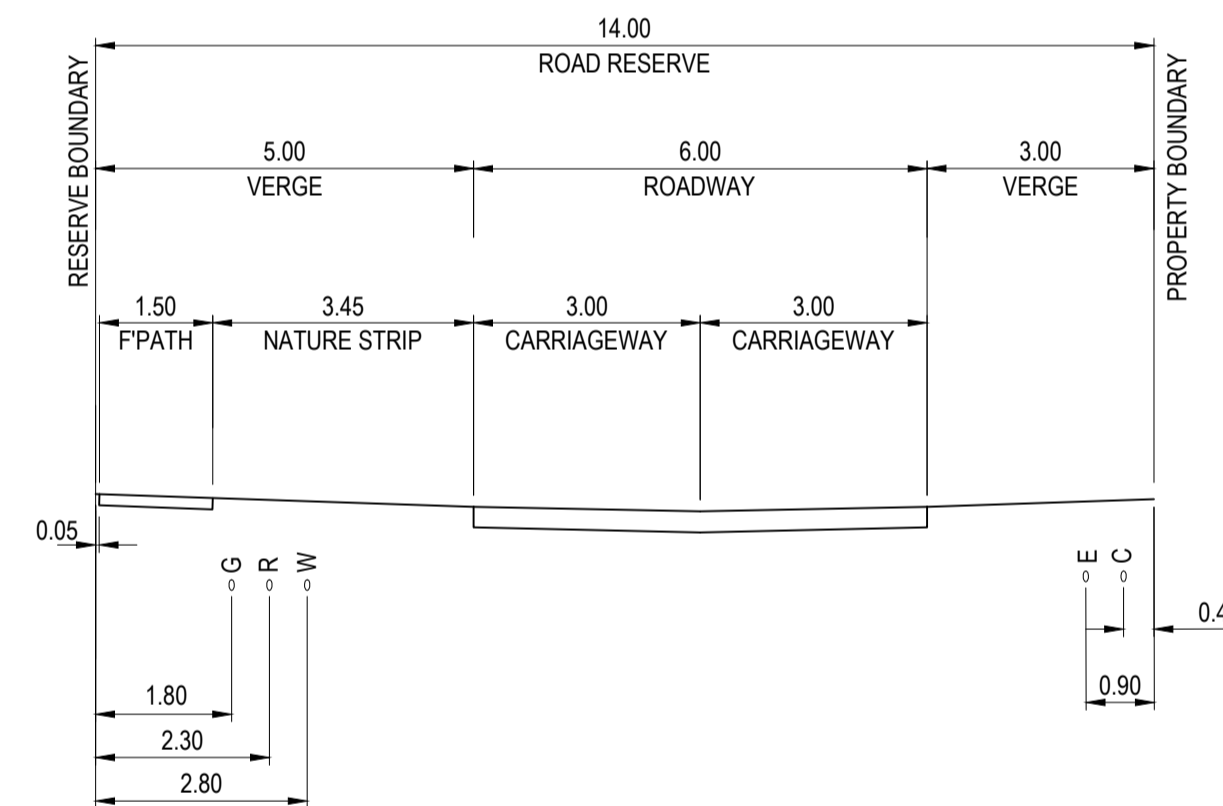

14.00m ROAD RESERVE
YALCA WAY - TYPICAL SECTION - E

Issue	Description	By	Ckd	PM	Date
01	ISSUED TO CLIENT FOR REVIEW	WB	ZS	JM	23.04.21

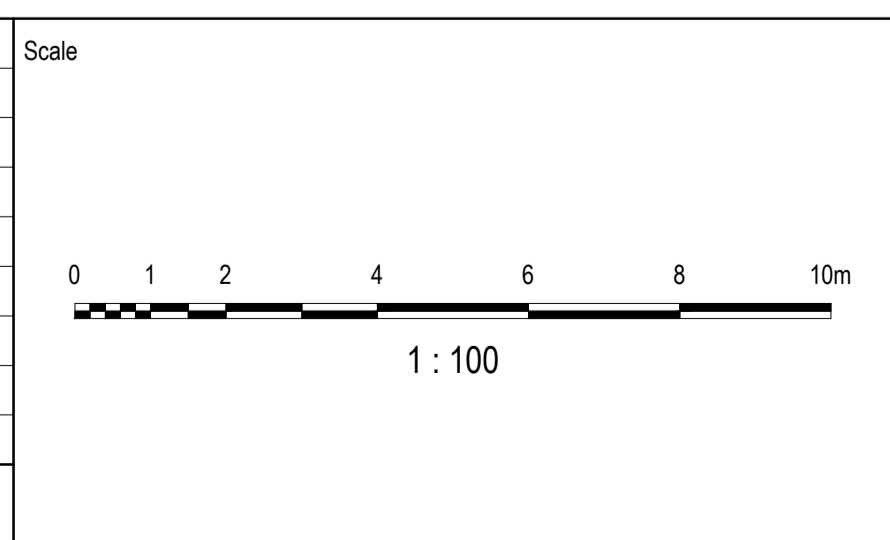

Planner

RD RobertsDay
 planning.design.place

Filename C-5C-820-10029435-TypicalCrossSections.dwg

Client

RESIMAX
 GROUP

Status	FOR APPROVAL CONSTRUCTION SUBJECT TO APPROVAL	
Checker	Z.STROGUSZ	
Original Issue Signatures	Drawn	Designed
Scales	1:100	K.ANGELES
Original Size	A1	Project Manager
Height Datum	AHD	J.MUNRO
Grid	MGA	© Copyright reserved

Project

EYNESBURY TOWNSHIP
 STAGE 5C
 CITY OF MELTON

Title

TYPICAL ROAD
 CROSS SECTIONS

Arcadis Australia Pacific Pty Limited
 Level 32, 140 William Street
 Melbourne VIC 3000
 ABN 76 104 485 289
 Tel No: +61 3 8623 4000
 www.arcadis.com

Drawing No. C-5C-820 — Project No. 10029435 — Issue 01

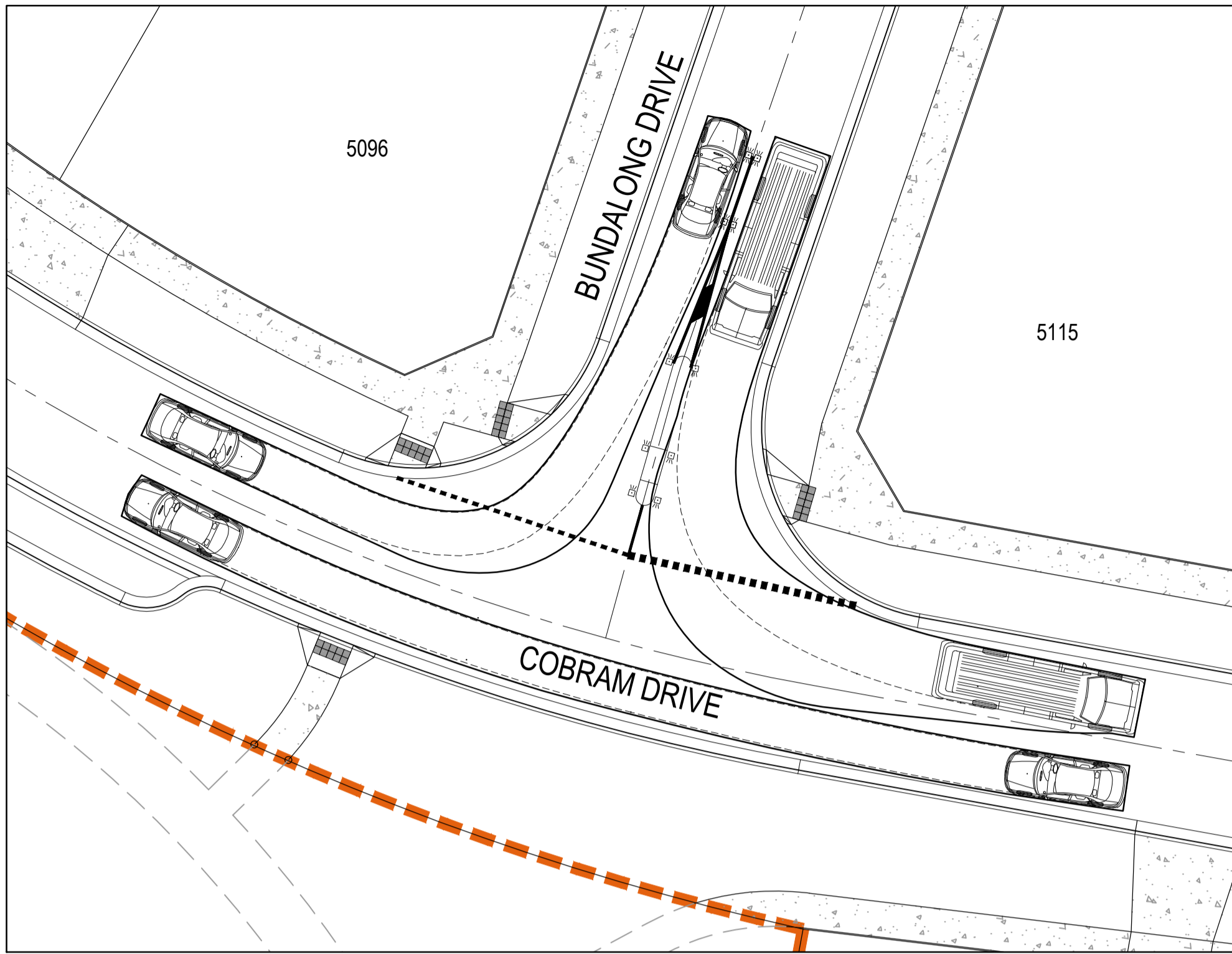

COBRAM DRIVE / BUNDALONG DRIVE TURN PATH LAYOUT 1

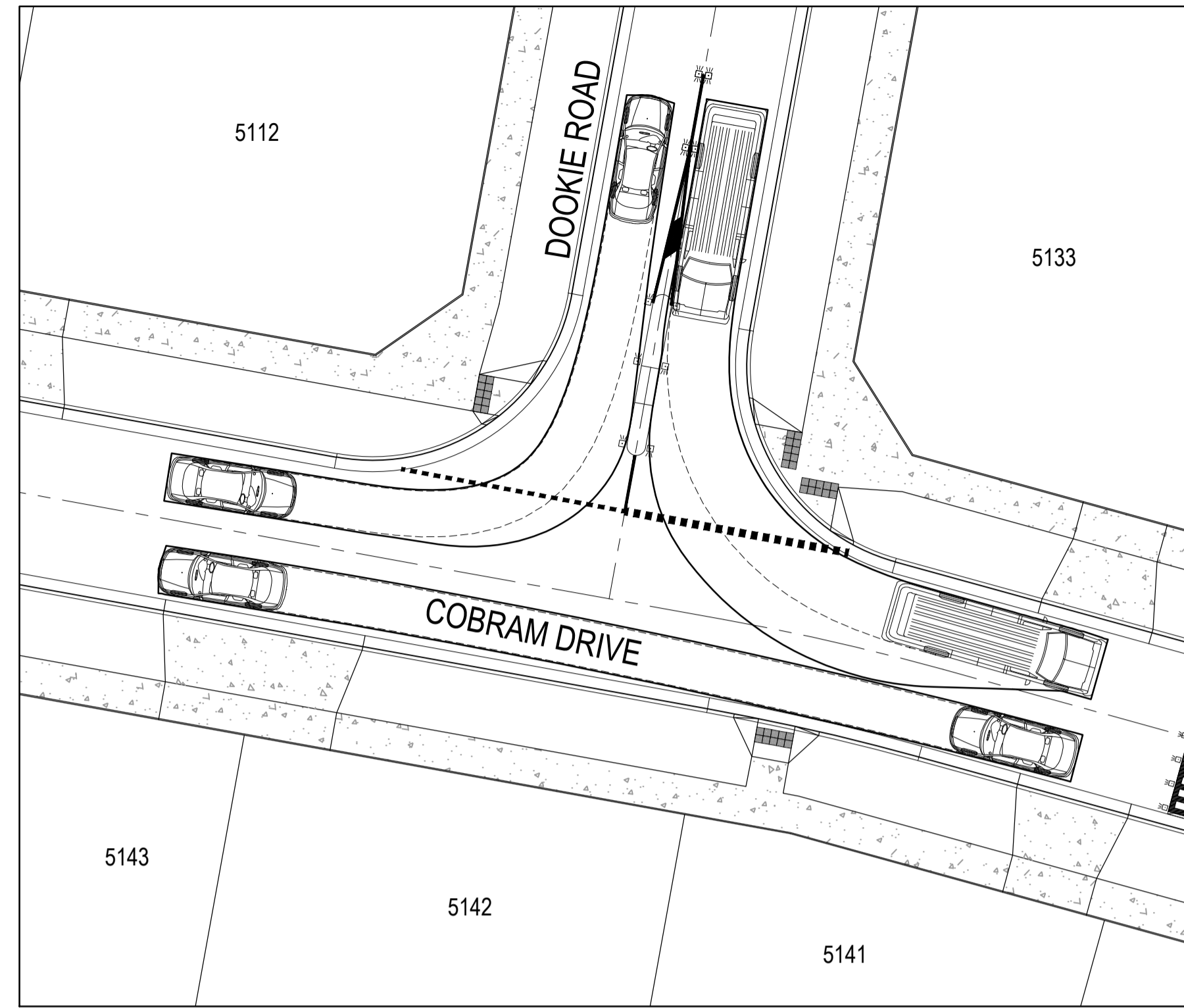

COBRAM DRIVE / DOOKIE ROAD TURN PATH LAYOUT 1

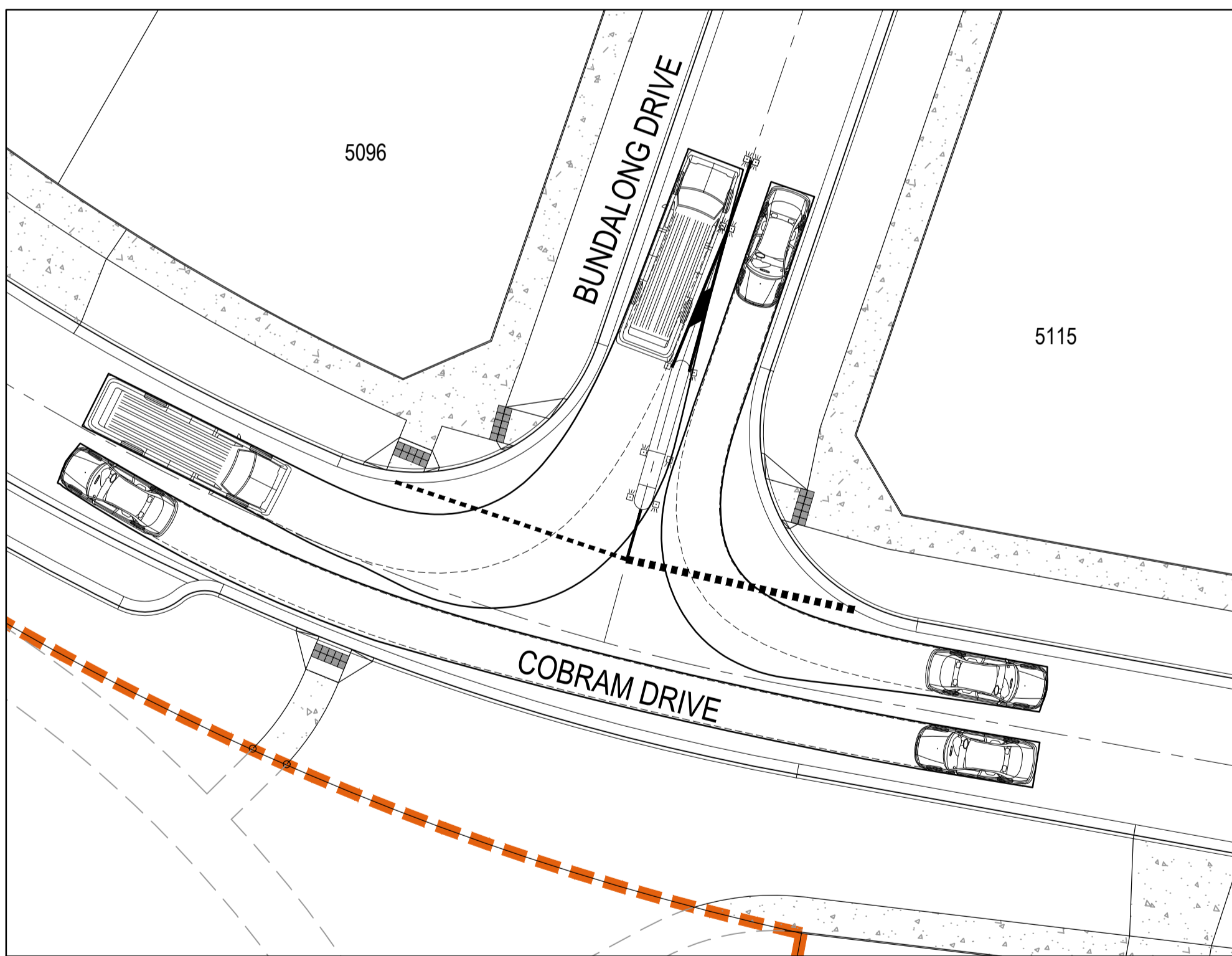

COBRAM DRIVE / BUNDALONG DRIVE TURN PATH LAYOUT 2

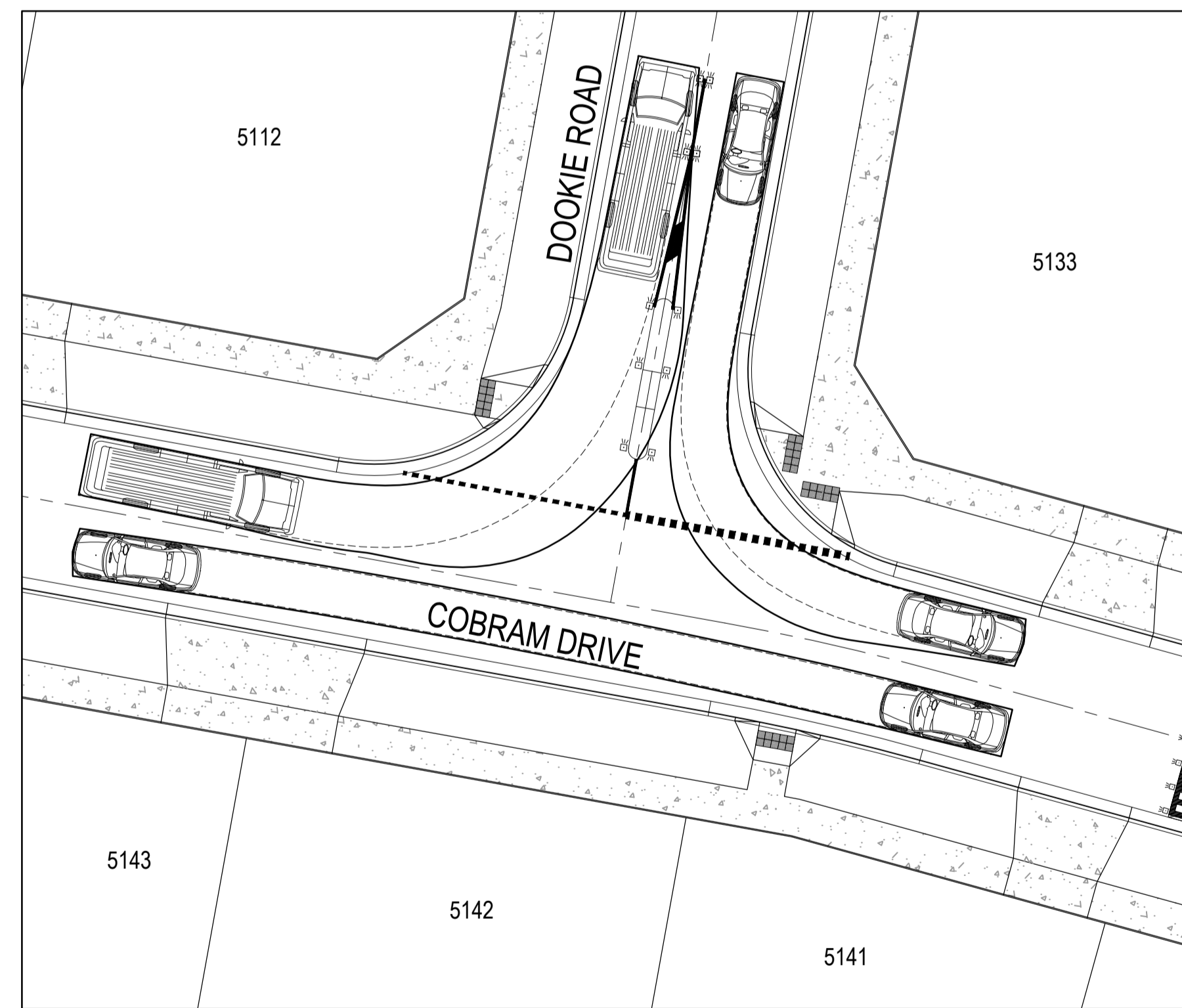

COBRAM DRIVE / DOOKIE ROAD TURN PATH LAYOUT 2

LEGEND

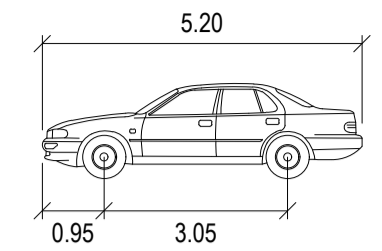

CAR	METERS
WIDTH	: 1.94
TRACK	: 1.84
LOCK TO LOCK TIME	: 6.0
STEERING ANGLE	: 33.6

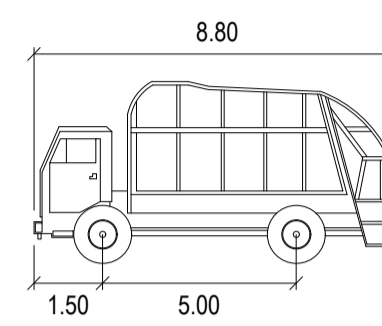

SERVICE VEHICLE	METERS
WIDTH	: 2.50
TRACK	: 2.50
LOCK TO LOCK TIME	: 6.0
STEERING ANGLE	: 38.7

Issue	Description	By	Ckd	PM	Date
01	ISSUED TO CLIENT FOR REVIEW	WB	ZS	JM	23.04.21

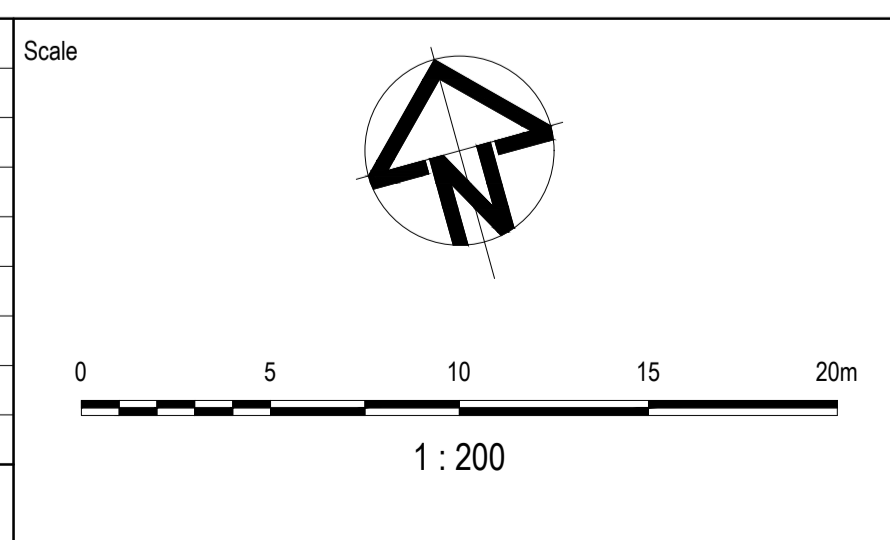

Planner

RobertsDay
planning.design.place

Filename C-5C-840-10029435-TurningPathAnalysis.dwg

Client

Status	FOR APPROVAL CONSTRUCTION SUBJECT TO APPROVAL	
Checker	Z.STROGUSZ	
Scales	1:200	Original Issue Signatures
	Original Size	A1
Height Datum	AHD	Designed K.ANGELES
Grid	MGA	Project Manager J.MUNRO
		© Copyright reserved

Project	EYNESBURY TOWNSHIP STAGE 5C CITY OF MELTON
Title	TURNING PATH ANALYSIS PLAN SHEET 1 OF 2

Arcadis Australia Pacific Pty Limited
Level 32, 140 William Street
Melbourne VIC 3000
ABN 76 104 485 289
Tel No: +61 3 8623 4000
www.arcadis.com

Drawing No.	Project No.	Issue
C-5C-840	10029435	01

LEGEND

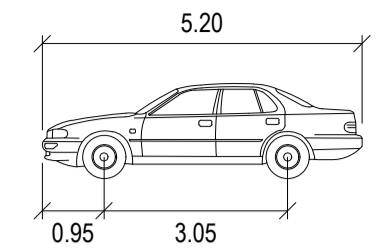

CAR	METERS
WIDTH	: 1.94
TRACK	: 1.84
LOCK TO LOCK TIME	: 6.0
STEERING ANGLE	: 33.6

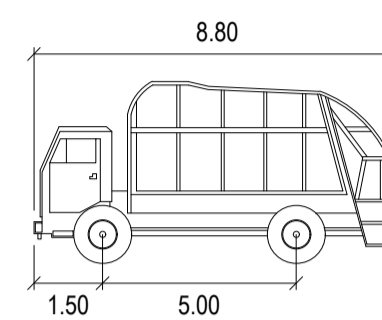

SERVICE VEHICLE	METERS
WIDTH	: 2.50
TRACK	: 2.50
LOCK TO LOCK TIME	: 6.0
STEERING ANGLE	: 38.7

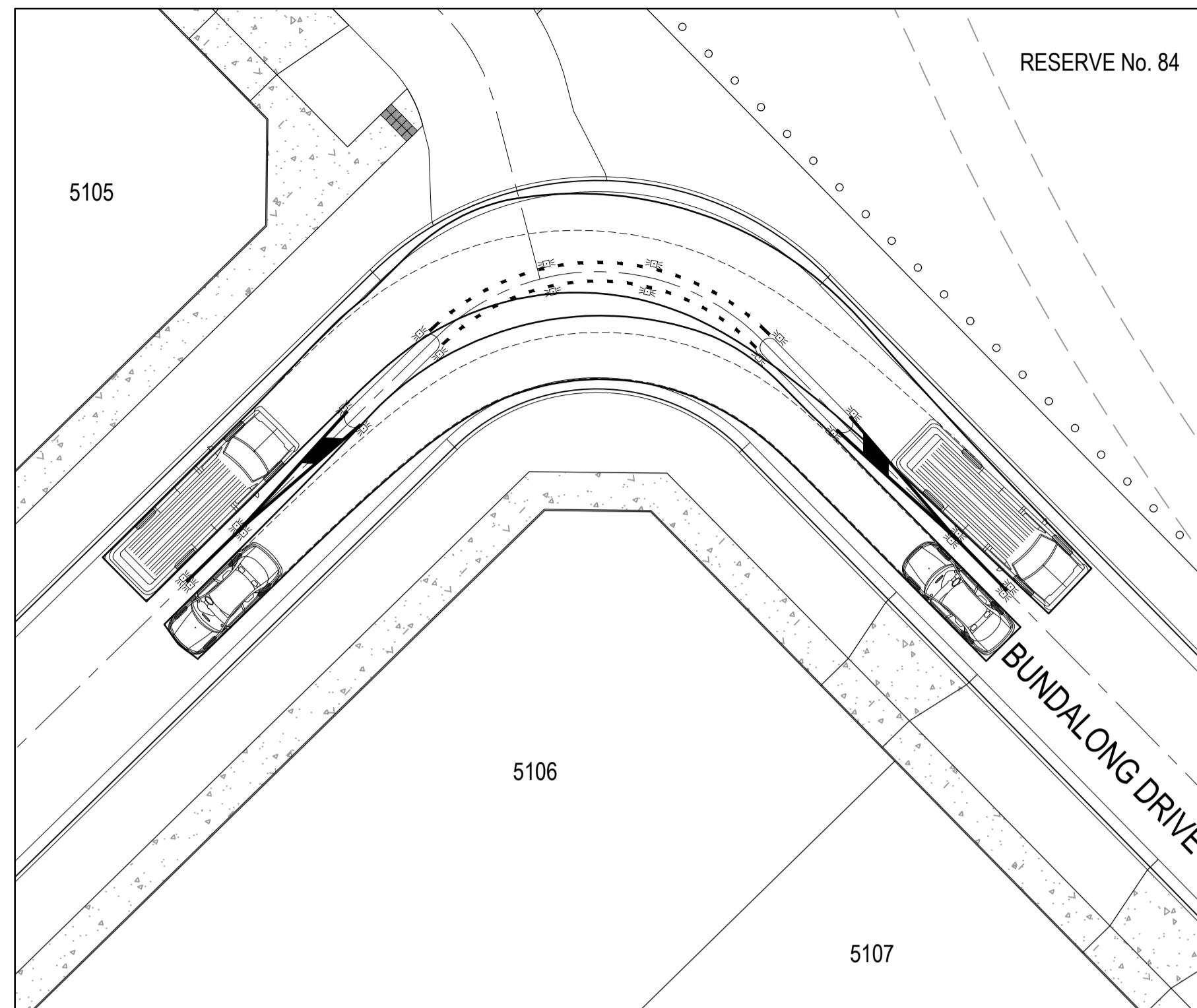

LOT 5106 BUNDALONG DRIVE TURN PATH LAYOUT 1

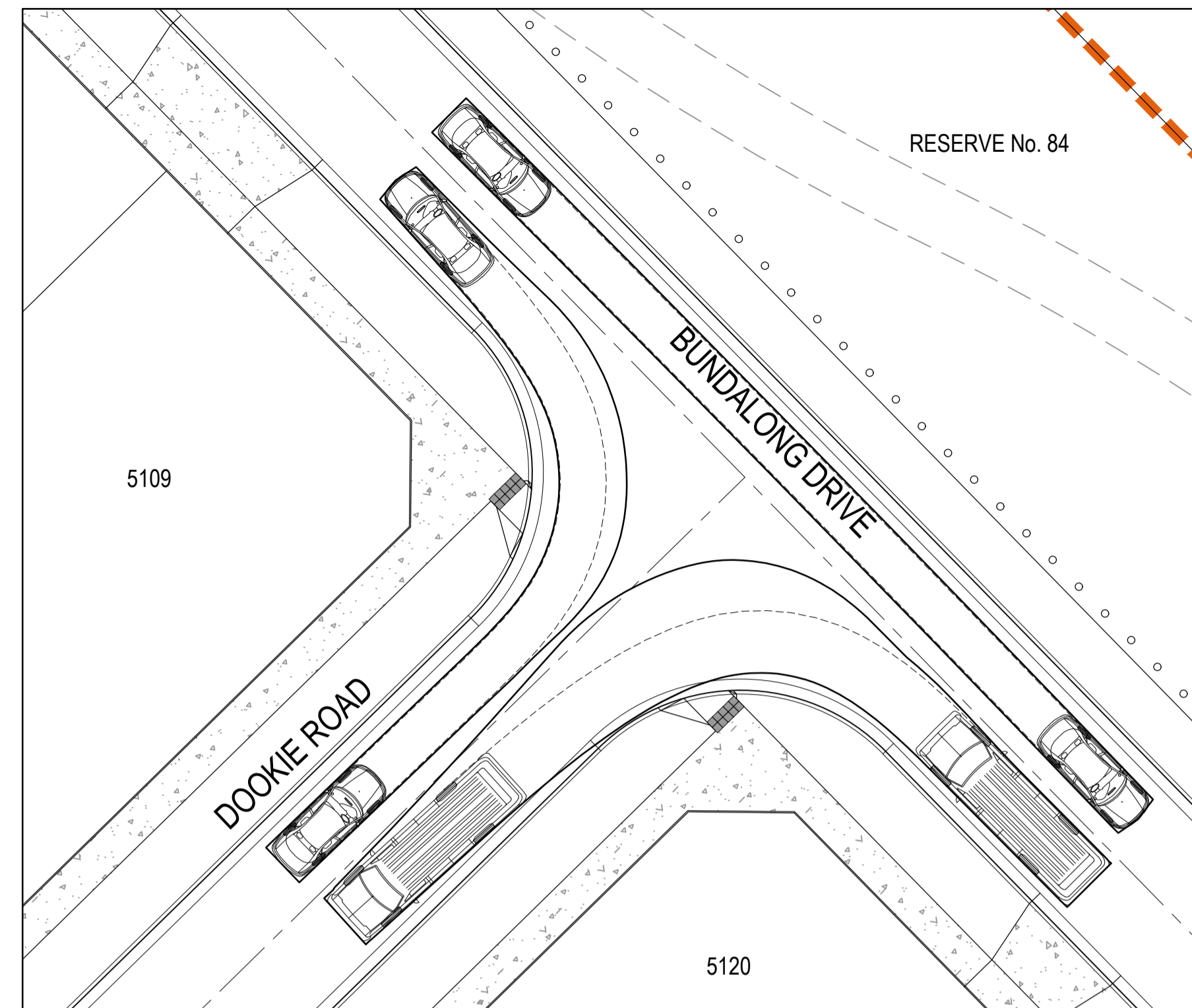

BUNDALONG DRIVE / DOOKIE ROAD TURN PATH LAYOUT 1

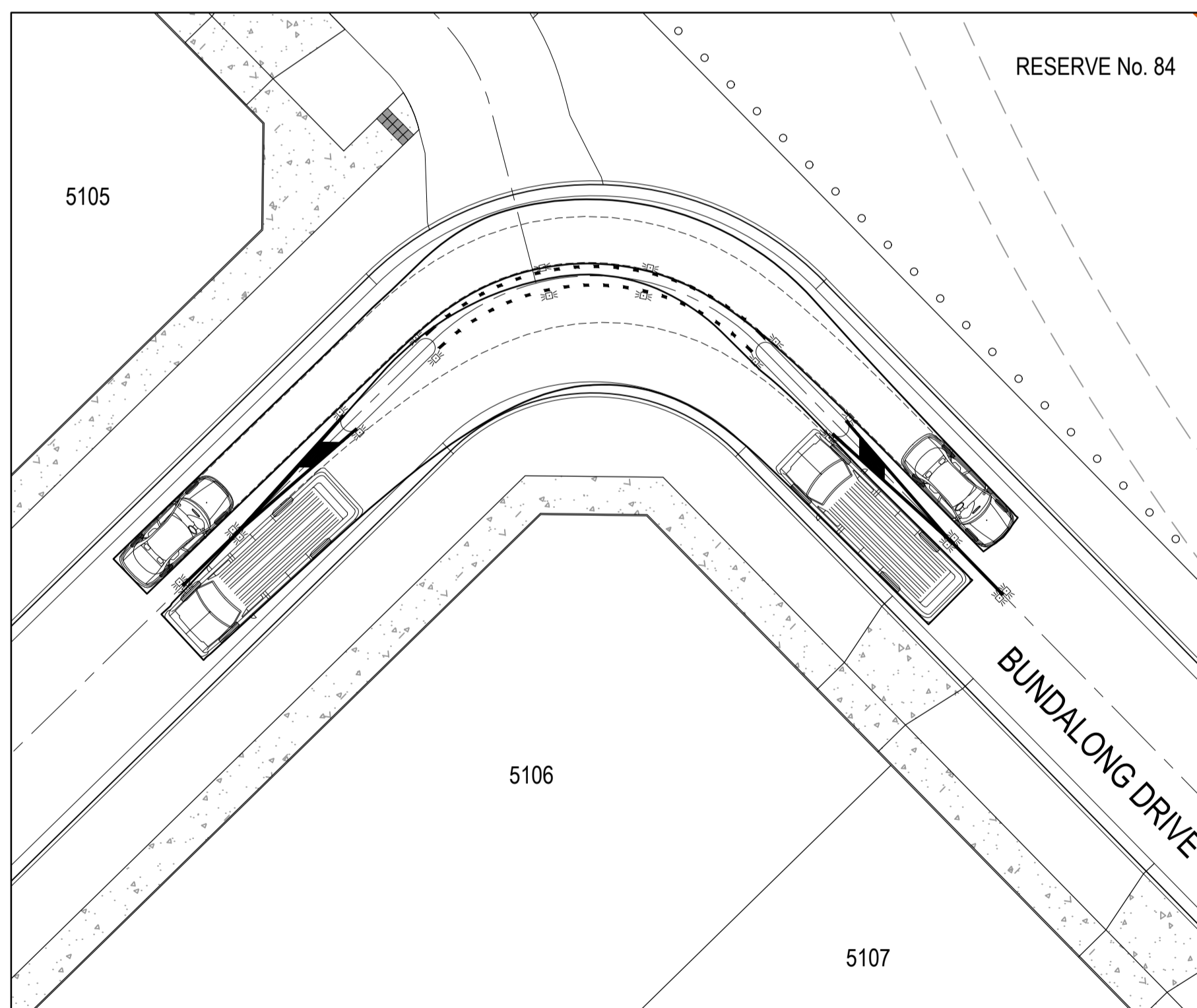

LOT 5106 BUNDALONG DRIVE TURN PATH LAYOUT 2

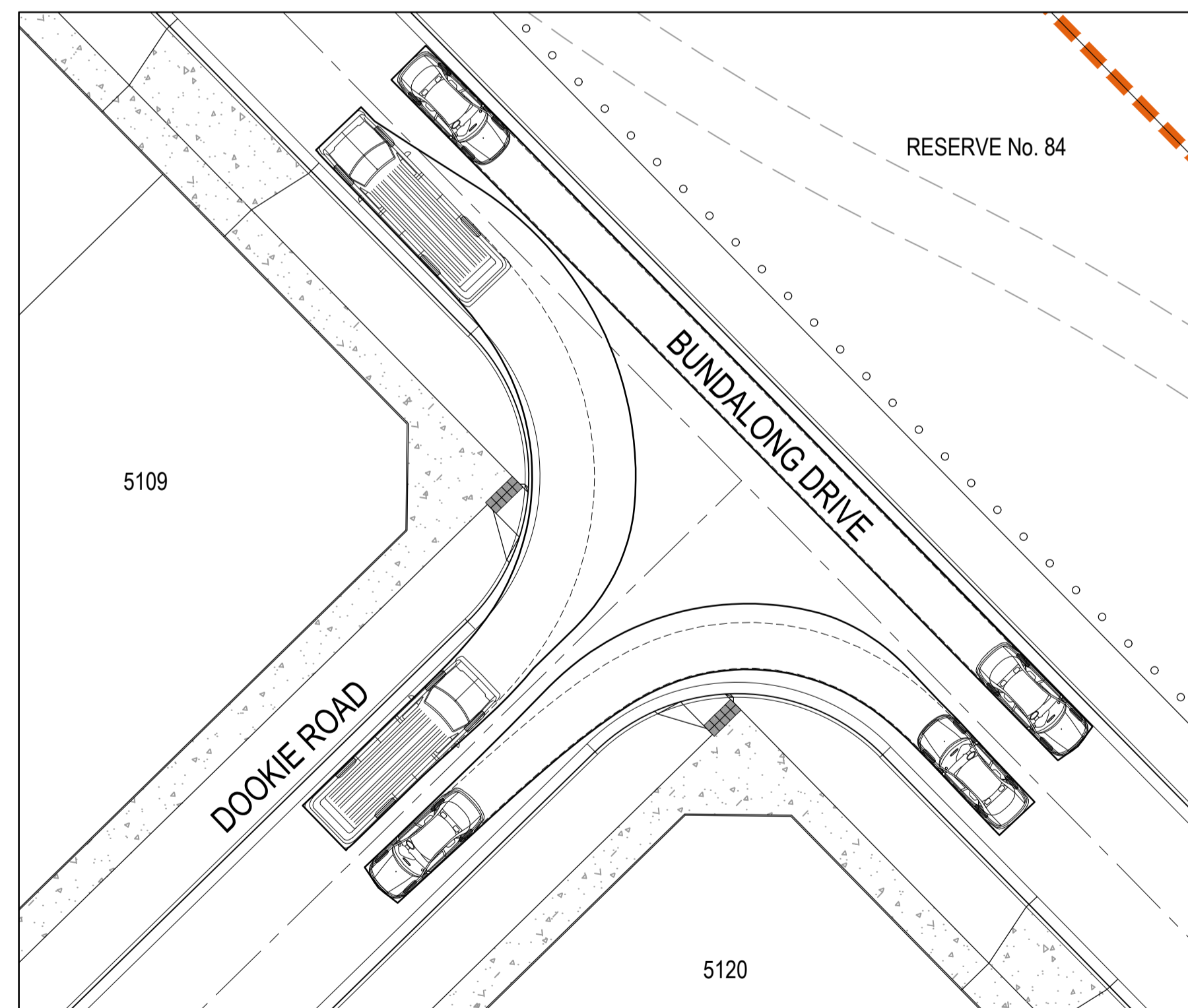

BUNDALONG DRIVE / DOOKIE ROAD TURN PATH LAYOUT 2

Issue	Description	By	Ckd	PM	Date
01	ISSUED TO CLIENT FOR REVIEW	WB	ZS	JM	23.04.21

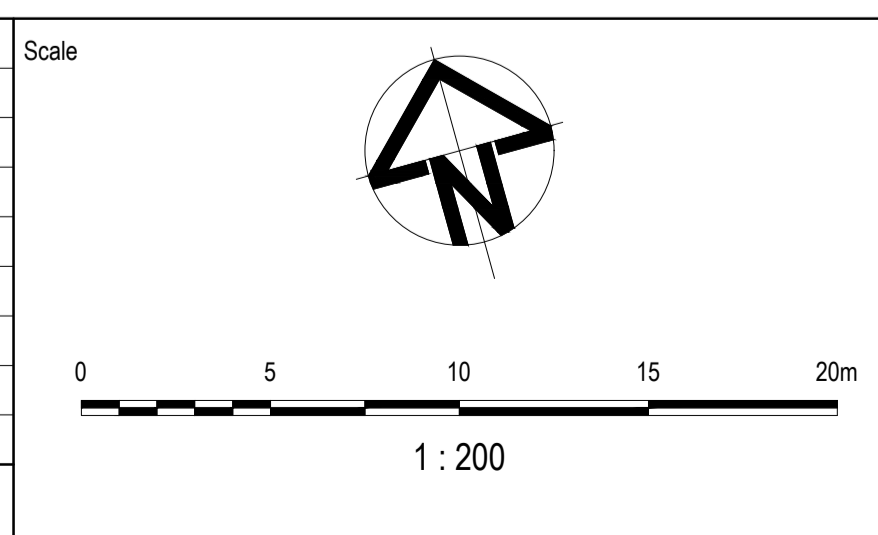

Planner

RD RobertsDay
planning.design.place

Filename C-5C-841-10029435-TurningPathAnalysis.dwg

Client

RESIMAX
GROUP

Status	FOR APPROVAL CONSTRUCTION SUBJECT TO APPROVAL	
Checker	Z.STROGUSZ	
Scales	1:200	Original Issue Signatures
	Original Size	Drawn W.BUMAGAT
Height Datum	AHD	Designed K.ANGELES
Grid	MGA	Project Manager J.MUNRO
© Copyright reserved		

Project

EYNEBURY TOWNSHIP
STAGE 5C
CITY OF MELTON

Title

TURNING PATH ANALYSIS PLAN
SHEET 2 OF 2

Arcadis Australia Pacific Pty Limited
Level 32, 140 William Street
Melbourne VIC 3000
ABN 76 104 485 289
Tel No: +61 3 8623 4000
www.arcadis.com

Drawing No. C-5C-841 — Project No. 10029435 — Issue 01



Issue	Description	By	Ckd	PM	Date
01	ISSUED TO CLIENT FOR REVIEW	WB	ZS	JM	23.04.21

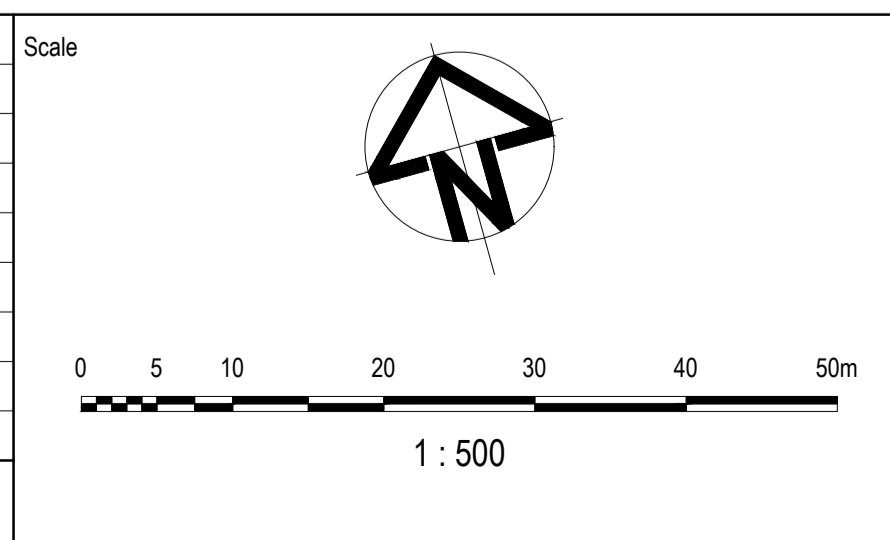

Planner

RD RobertsDay
planning-design-place

Client

RESIMAX
GROUP

Filename C-5C-860-10029435-CarParkLayout.dwg

Status

FOR APPROVAL
CONSTRUCTION SUBJECT TO APPROVAL

Checker
Z.STROGUSZ

Scales

1:500

Original Issue Signatures

Original Size
A1

Height Datum
AHD

Grid
MGA

Drawn
W.BUMAGAT

Designed
K.ANGELES

Project Manager
J.MUNRO

© Copyright reserved

Project

EYNESBURY TOWNSHIP
STAGE 5C
CITY OF MELTON

Title

CARPARK LAYOUT PLAN

Arcadis Australia Pacific Pty Limited
Level 32, 140 William Street
Melbourne VIC 3000
ABN 76 104 485 289
Tel No: +61 3 8623 4000
www.arcadis.com

Drawing No. **C-5C-860** Project No. **10029435** Issue **01**