

**STAGE 18A 47 Lots**  
**STAGE 18B 42 Lots**  
**STAGE 18C 61 Lots**  
**STAGE 18D 39 Lots**  
**STAGE 19 24 Lots**  
**STAGES 18 & 19 TOTAL 213 Lots**

**LEGEND**

- C CLASSIC STANDARD ALLOTMENT
- P PREMIUM STANDARD ALLOTMENT
- N NORTH FACING ALLOTMENT
- D DOUBLE STOREY ALLOTMENTS
- F FENCING OVERLAY
- B BATTLEAXE ALLOTMENT OVERLAY
- R ALLOTMENTS ADJOINING PUBLIC RESERVES
- H HABITABLE FLOOR SPACE ABOVE GARAGE AS PER ENDORSED PLAN BY COUNCIL

NOTE : 0 or 1.5m = 0-200mm or 1.5m SIDE SETBACK

MGA94 ZONE 55

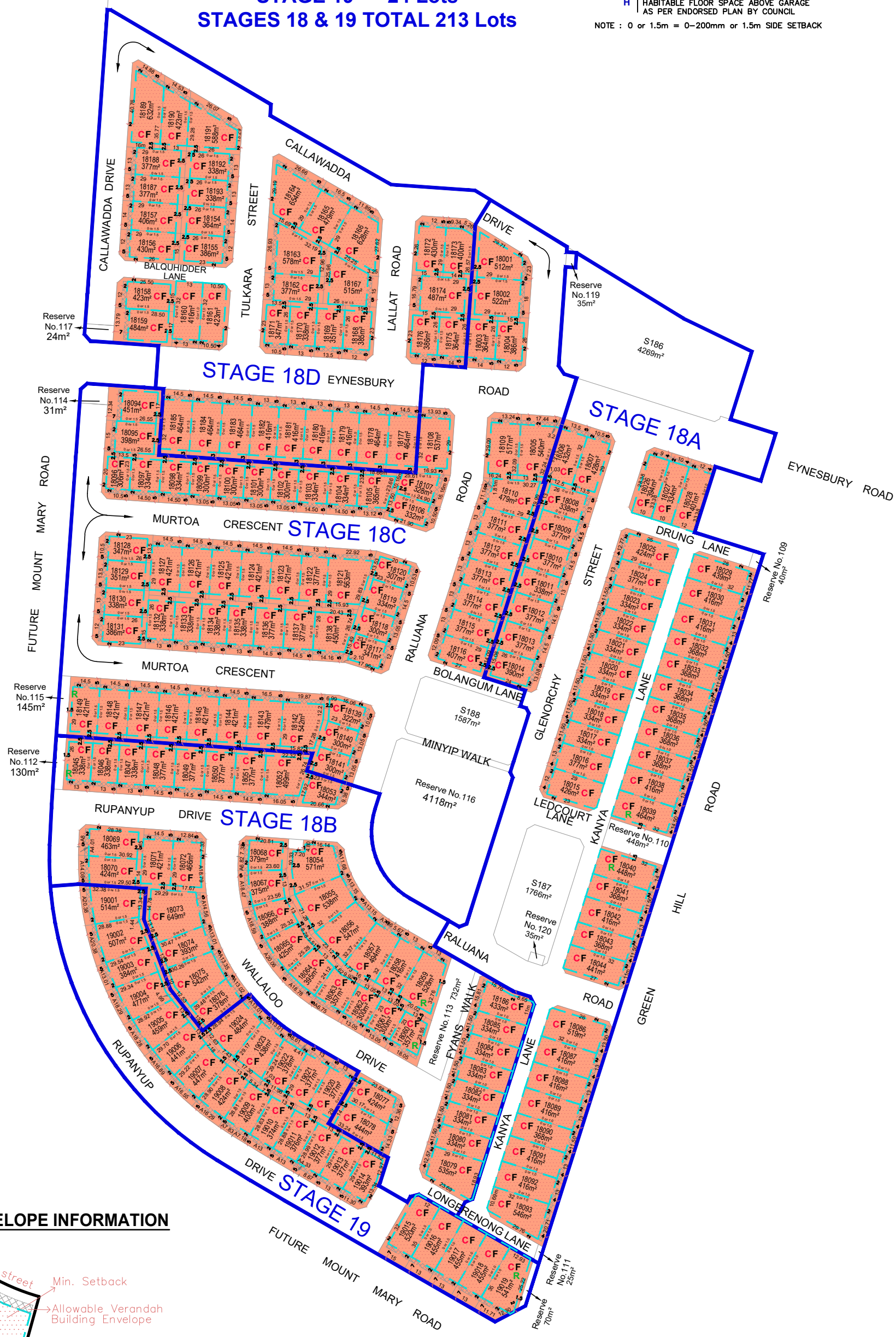

**BUILDING ENVELOPE INFORMATION**

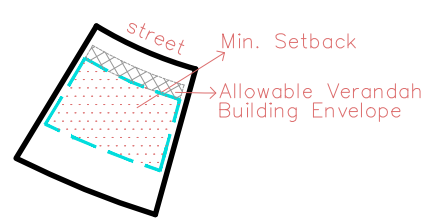

c:\users\lap\taylorsonline\development\strategists\pty\td\09283 - documents\09283\09283\urban design\stage 18 & 19\09283 - stages 18-19 design\guidelines - uds.dwg | 1