



PLAN OF SUBDIVISION		EDITION 1	PS543210K/S153	
LOCATION OF LAND PARISH: MOORADORANOOK TOWNSHIP: SECTION: REFER TO REGISTERED MASTER CROWN ALLOTMENT: PLAN FOR CROWN DESCRIPTIONS CROWN PORTION: TITLE REFERENCE: Vol. Fol. LAST PLAN REFERENCE: PS543210K Lot S153 POSTAL ADDRESS: Batchica Street (at time of subdivision) Eynesbury 3338 MGA 94 CO-ORDINATES: E: 283 430 ZONE: 55 (of approx centre of N: 5 815 550 land in plan)		COUNCIL NAME: MELTON CITY COUNCIL		
VESTING OF ROADS AND/OR RESERVES		NOTATIONS		
IDENTIFIER	COUNCIL/BODY/PERSON	LOTS IN THIS PLAN MAY BE AFFECTED BY ONE OR MORE OWNERS CORPORATIONS For details of any Owners Corporations including purpose, responsibility, entitlement & liability see owners corporation search report, owners corporation additional information and if applicable, owners corporation rules. Lots 15111 to 15140 have been omitted from this plan OTHER PURPOSE OF PLAN To remove that part of easement E-41 created on PS543210K in so far as it lies within Road R87 herein. GROUNDS FOR REMOVAL: By agreement between all interested parties pursuant to Section 6(1)(k)(iv) of the Subdivision Act 1988.		
Road R87 Reserve No.128	MELTON CITY COUNCIL POWERCOR AUSTRALIA LTD			
NOTATIONS				
DEPTH LIMITATION: Does Not Apply				
SURVEY: This plan is based on survey. STAGING: This is a staged subdivision. Planning Permit No. PA2021/7550				
EYNESBURY - Stage 153 (Eynesbury Marketing Stage 15C) Area of Release: 8332m ² No. of Lots: 14 Lots				
EASEMENT INFORMATION				
LEGEND: A - Appurtenant Easement E - Encumbering Easement R - Encumbering Easement (Road)				
Easement Reference	Purpose	Width (Metres)	Origin	Land Benefited/In Favour Of
EASEMENTS E-1 TO E-68 HAVE BEEN OMITTED FROM THIS PLAN				
E-69	Sewerage	See Diag.	This Plan	City West Water Corporation
E-70	Drainage	See Diagram	This Plan	Melton City Council
	Sewerage			City West Water Corporation
				<div style="border: 2px solid red; padding: 5px; display: inline-block;"> DRAFT </div> <div style="border: 2px solid red; padding: 5px; display: inline-block;"> PRELIMINARY <small>THIS PLAN IS BASED ON DESIGN DRAWINGS BY Taylors (Taylors Subdivision Master Version 40) AND IS SUBJECT TO DESIGN CHANGES, VERIFICATION OF BOUNDARIES BY SURVEY, APPROVALS FROM COUNCIL AND REFERRAL AUTHORITIES, AND ULTIMATE REGISTRATION AT LAND REGISTRATION SERVICES.</small> </div>
 TAYLORS Urban Development Built Environments Infrastructure 8 / 270 Ferntree Gully Road, Notting Hill, Victoria, 3168 Tel: 61 3 9501 2800 Web: taylorsds.com.au		SURVEYORS FILE REF: Ref. 09283-S15C Ver. 2 Licensed Surveyor: LEO ALEXANDER BATEMAN / Version No 2	ORIGINAL SHEET SIZE: A3	SHEET 1 OF 2



PRELIMINARY

THIS PLAN IS BASED ON DESIGN DRAWINGS BY Taylors (Taylors Subdivision Master Version 40) AND IS SUBJECT TO DESIGN CHANGES, VERIFICATION OF BOUNDARIES BY SURVEY, APPROVALS FROM COUNCIL AND REFERRAL AUTHORITIES, AND ULTIMATE REGISTRATION AT LAND REGISTRATION SERVICES.

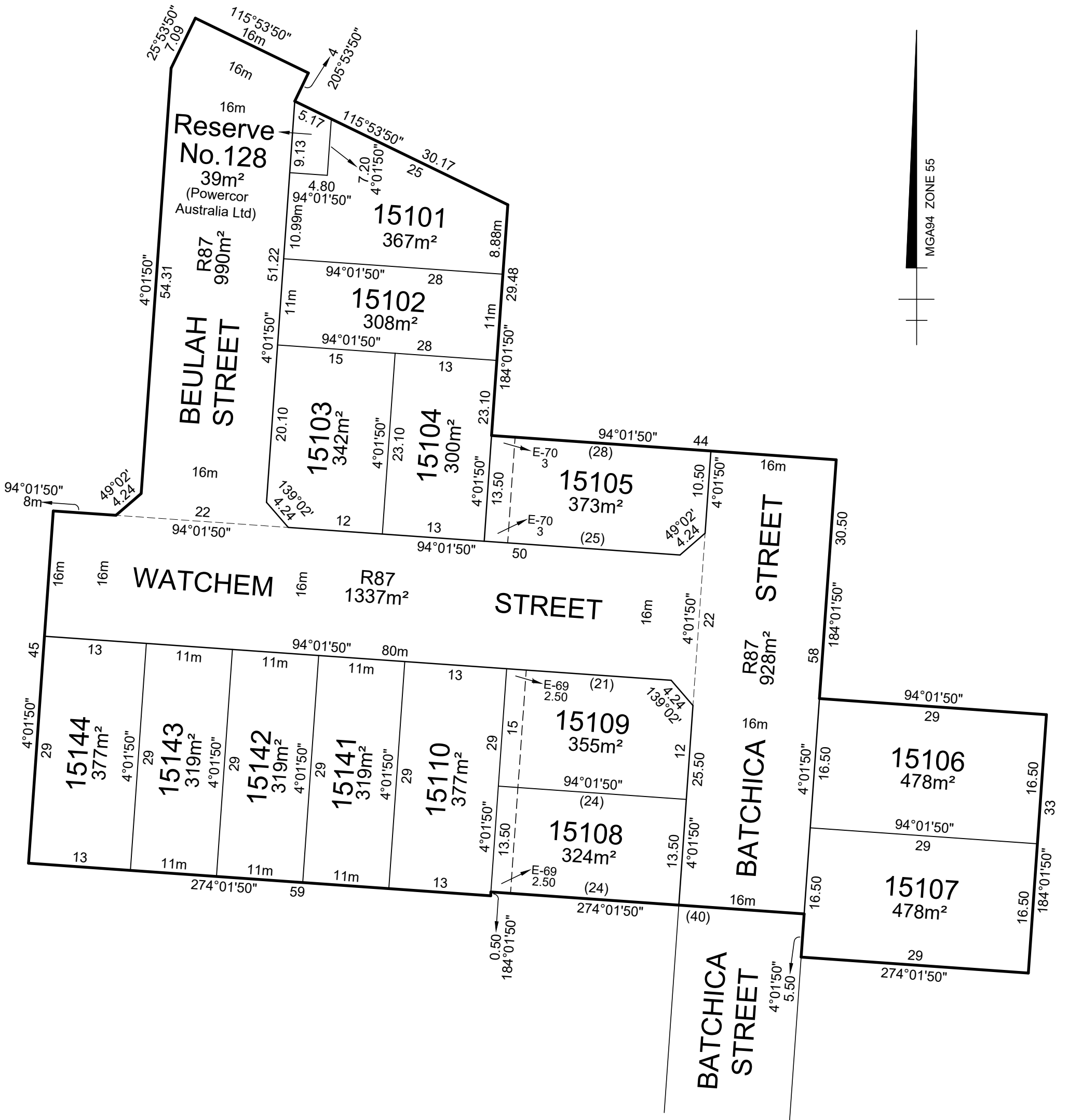
DRAFT



Urban Development | Built Environments | Infrastructure
 8 / 270 Ferntree Gully Road, Notting Hill, Victoria, 3168
 Tel: 61 3 9501 2800 | Web: taylorssds.com.au

SCALE
1:500

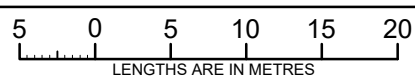

ORIGINAL SHEET
SIZE: A3

Ref. 09283-S15C
Ver. 2

SHEET 2

Licensed Surveyor:

LEO ALEXANDER BATEMAN / Version No 2

OWNERS CORPORATION SCHEDULE

PS543210K/S153

Owners Corporation No. 2 Plan No. PS543210K/S153

Land affected by Owners Corporation Lots: ALL OF THE LOTS IN THE TABLE BELOW
Common Property No.:

Limitations of Owners Corporation: UNLIMITED

Notations
NIL

Totals		
	Entitlement	Liability
This schedule	140	140
Previous stages	0	0
Overall Total	140	140

Lot Entitlement and Lot Liability

Lot	Entitlement	Liability	Lot	Entitlement	Liability	Lot	Entitlement	Liability	Lot	Entitlement	Liability
15101	10	10									
15102	10	10									
15103	10	10									
15104	10	10									
15105	10	10									
15106	10	10									
15107	10	10									
15108	10	10									
15109	10	10									
15110	10	10									
15141	10	10									
15142	10	10									
15143	10	10									
15144	10	10									



Urban Development | Built Environments
Infrastructure | Engineering and Project Management

8/270 Ferntree Gully Road, Notting Hill VIC 3168
Phone: (03) 9501 2800 | www.taylorsds.com.au

SURVEYORS FILE REFERENCE: 09283-15C

SHEET 1

ORIGINAL SHEET
SIZE: A3

LEO ALEXANDER BATEMAN / VERSION No. 2